

W H O W E H E A R D F R O M

- 2 Community Meetings attended by 469 community members.
- 209 community members provided feedback through questionnaires.
- 307 community members provided independent feedback through open channels.

What best describes you?

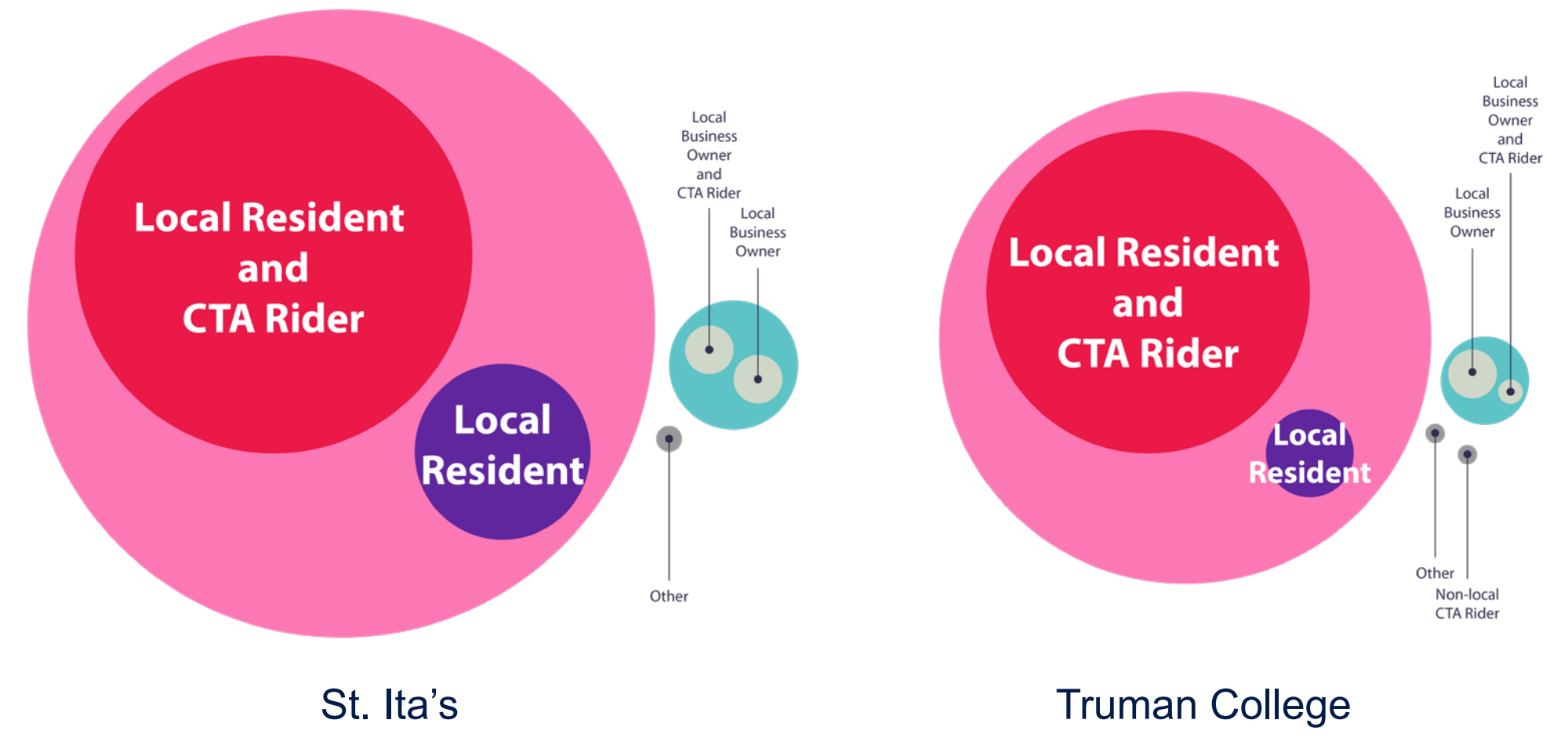

W H A T W E H E A R D

Most Common Themes

Most Common



1. Against Parking
2. Safety Concerns
3. Desire for Vendor / Market
4. Desire for Green Space
5. Desire for Bike Path

Parking Summary

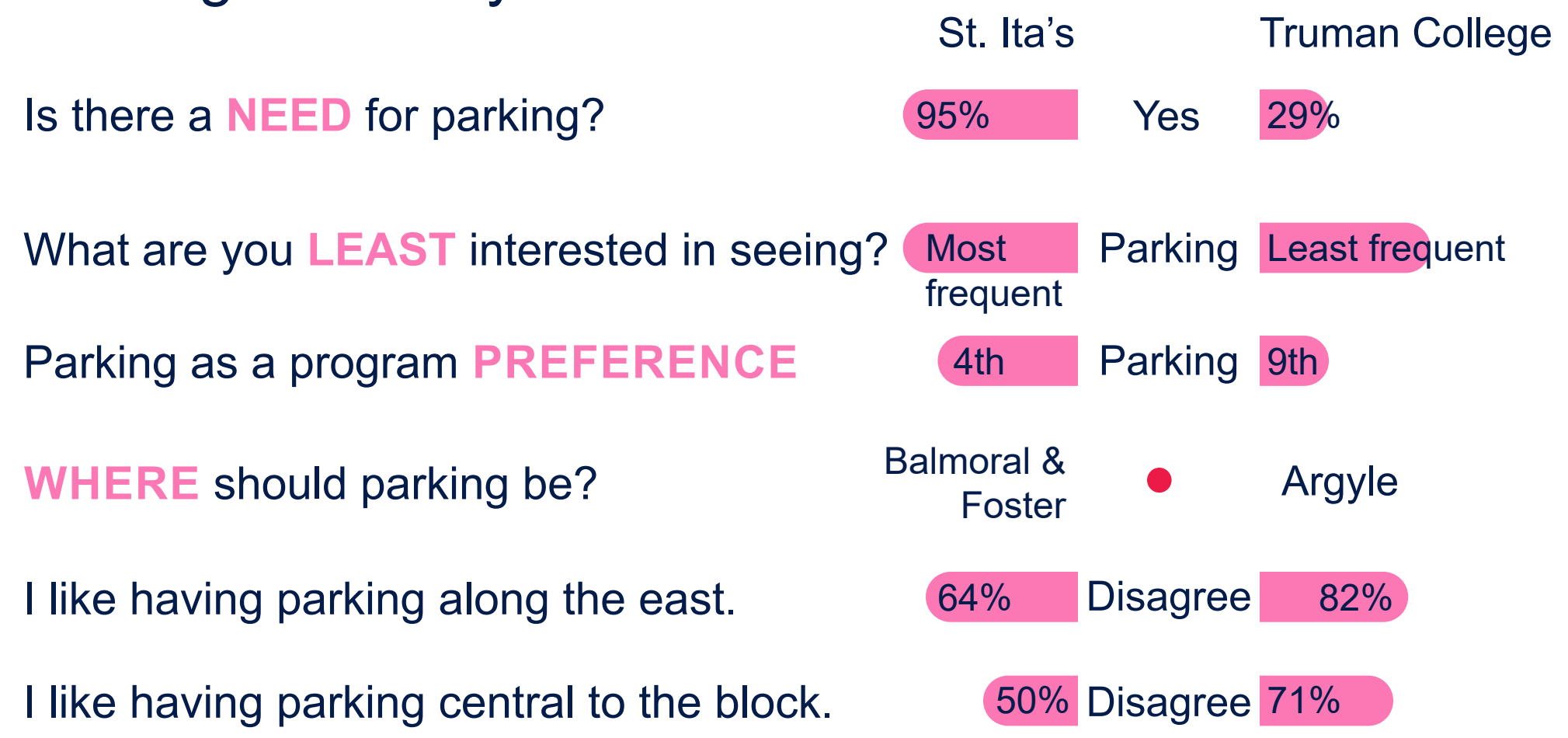

M O O D P R E F E R E N C E

Concept 1

Warm, textural, welcoming, contemporary

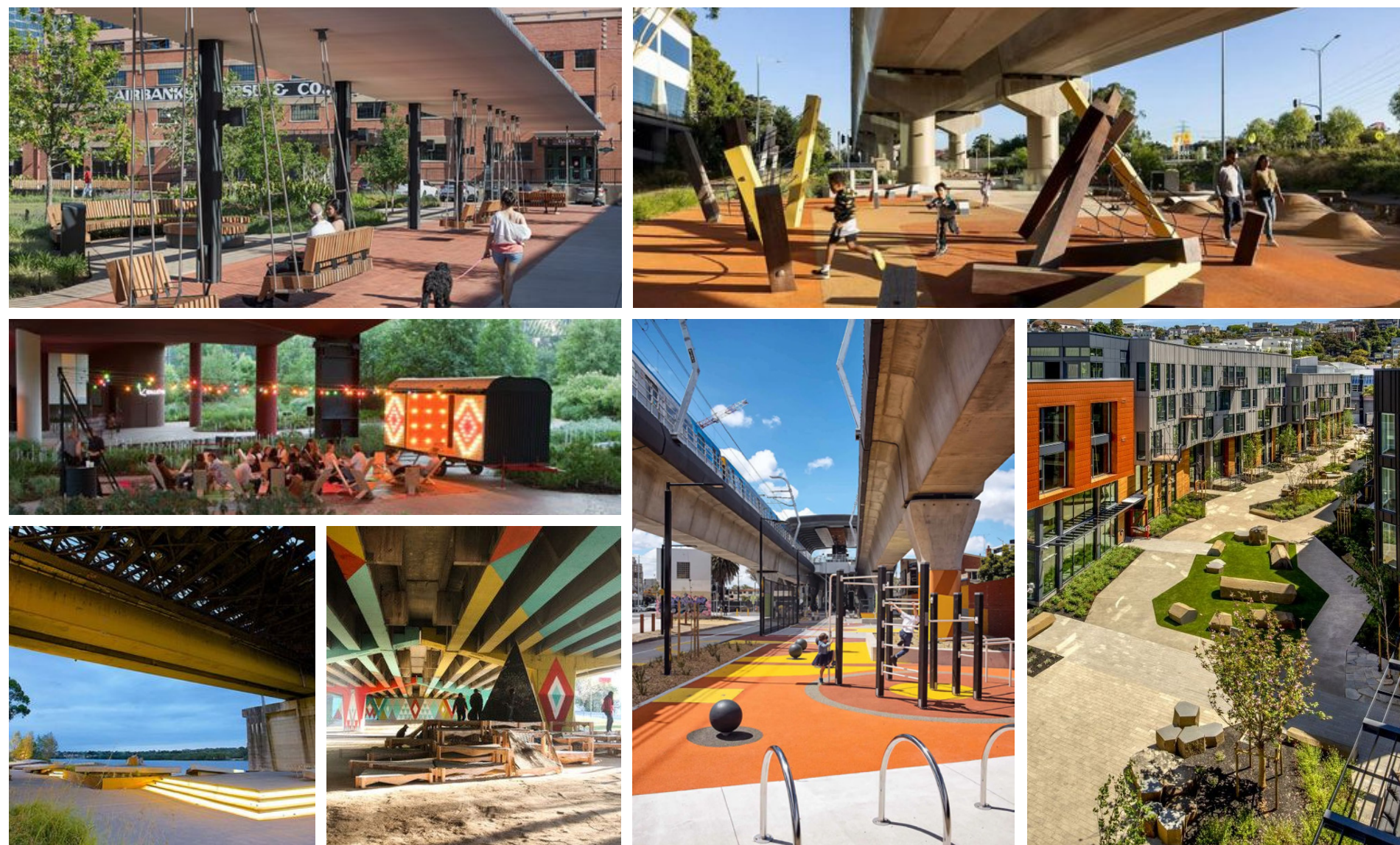

St. Ita's 33.04%

Truman College 55.66%

Concept 2

Rustic, natural, peaceful, green space



St. Ita's 56.52%

Truman College 37.74%

G U I D I N G P R I N C I P L E S

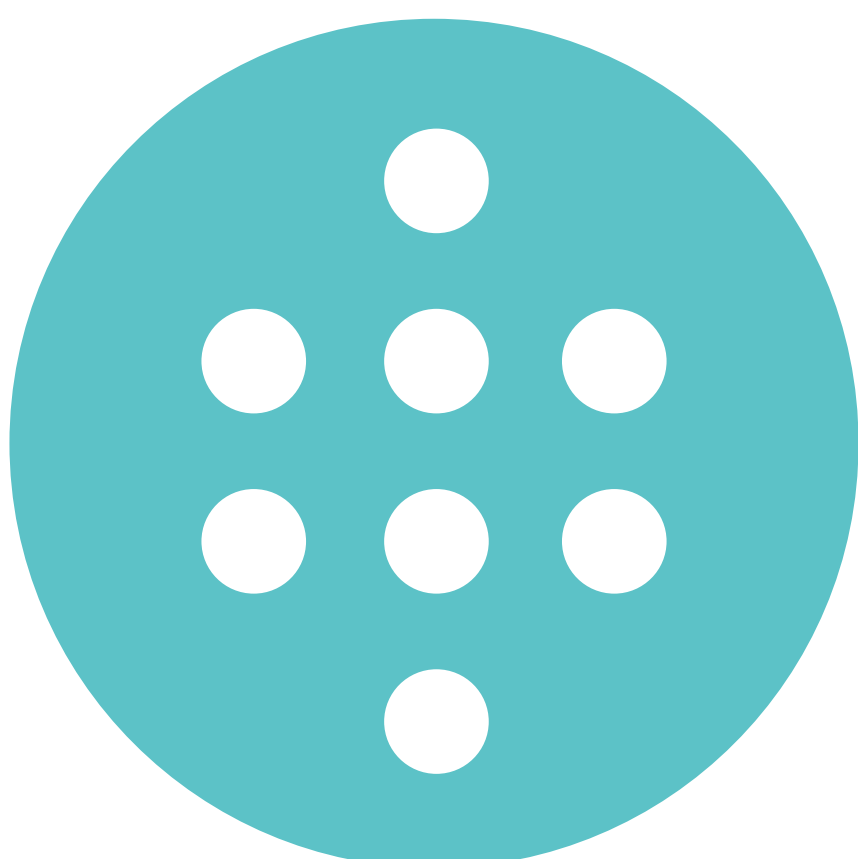

Creating a continuous rhythm of balanced program throughout the project area



Creating a continuous rhythm of balanced program throughout the project area



Amplifying neighborhood resources and providing needs that respond to public input



Celebrating neighborhood cultural assets

LAWRENCE TO BRYN MAWR UNDER 'L' ACTIVATION

L A Y O U T F E E D B A C K

Layout 1

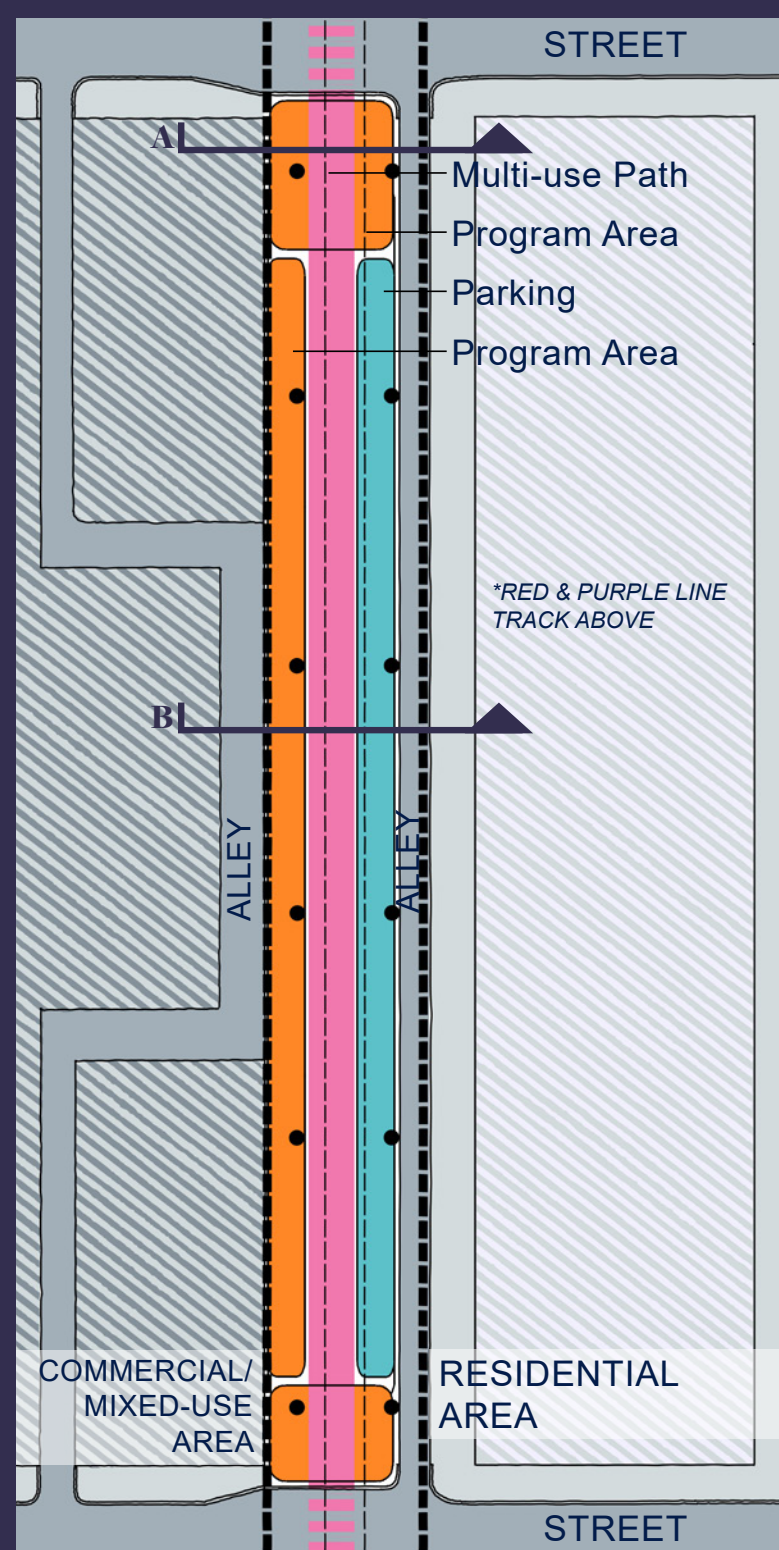
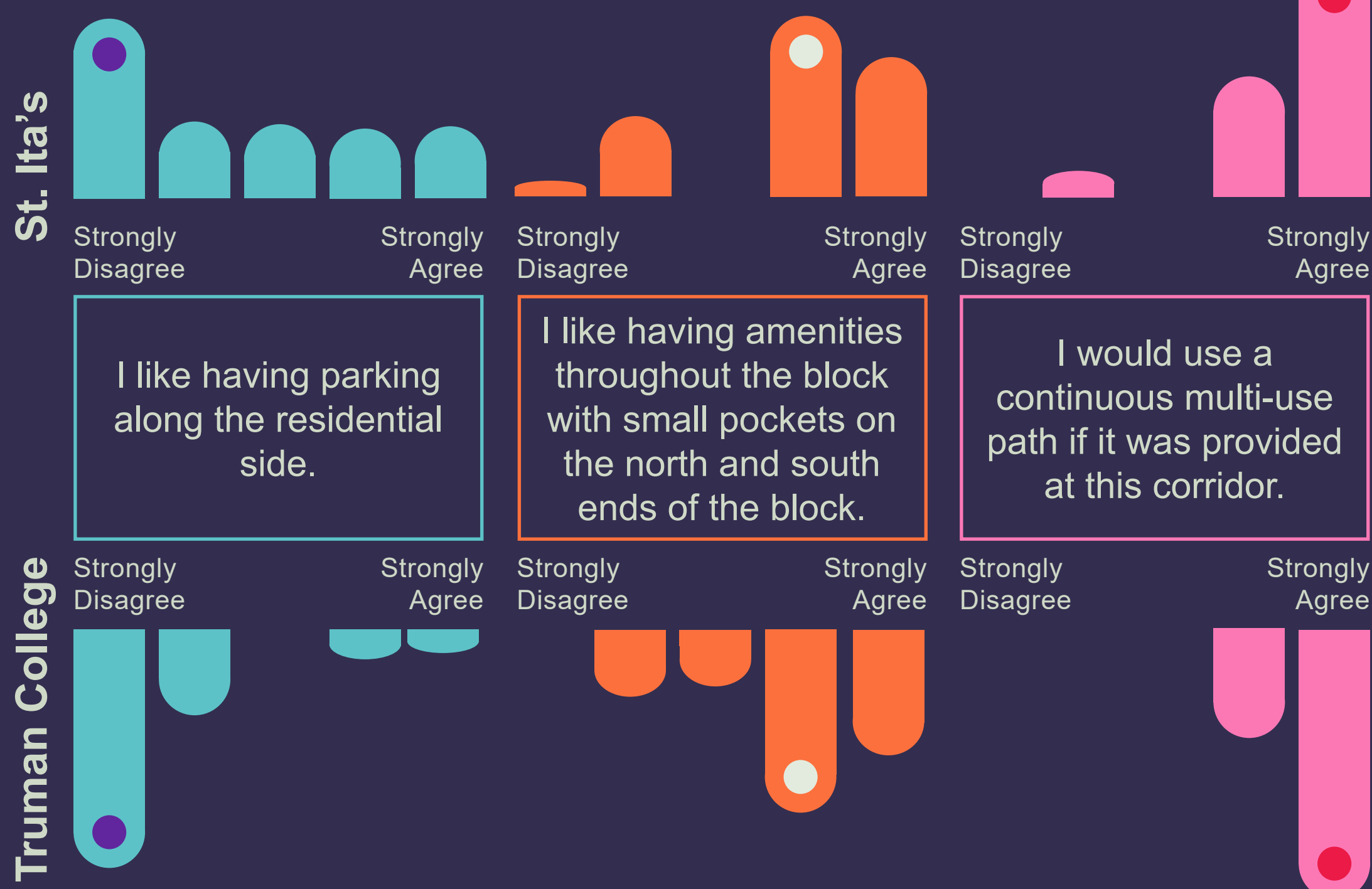

Section Conditions

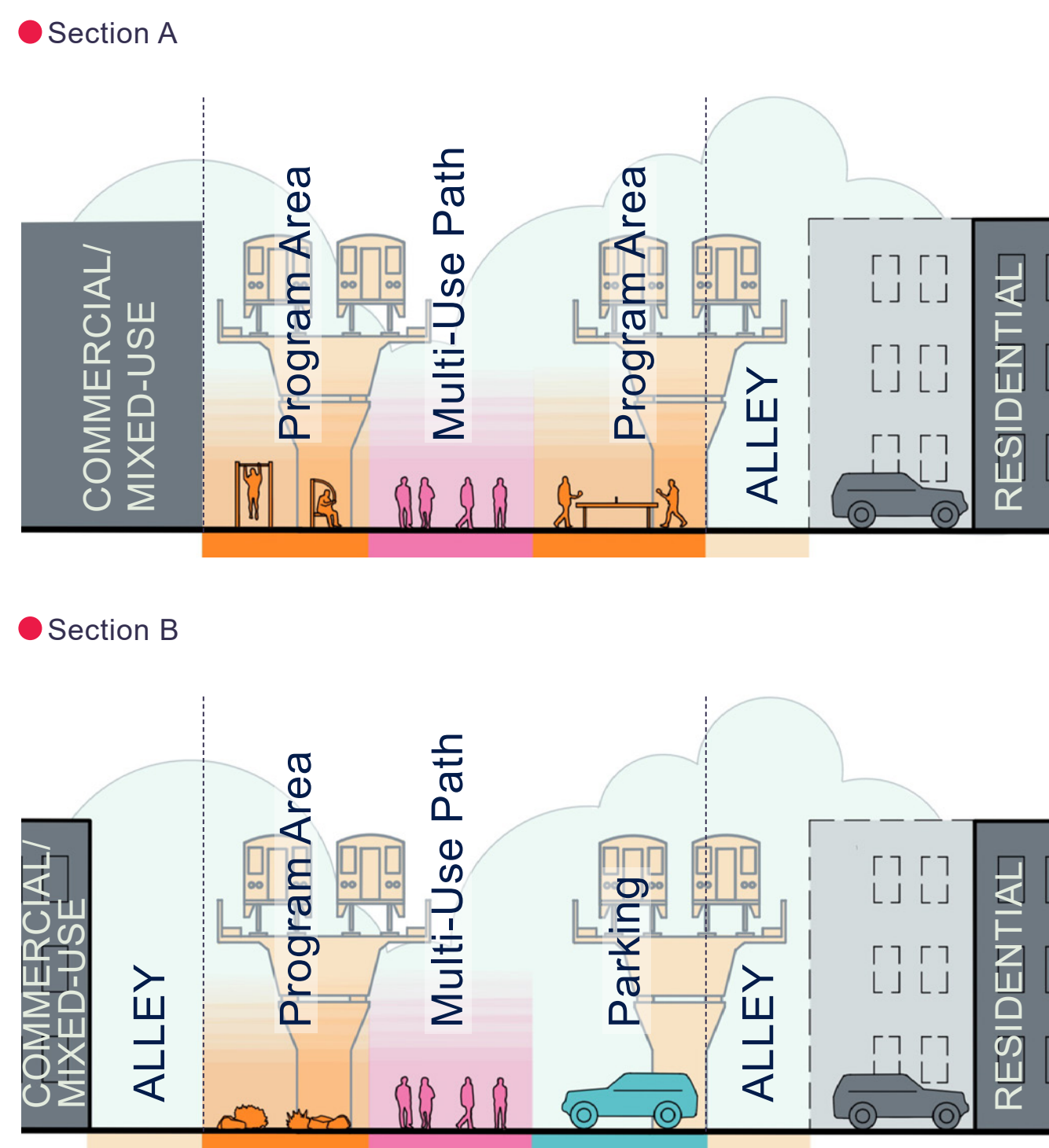

Layout 2

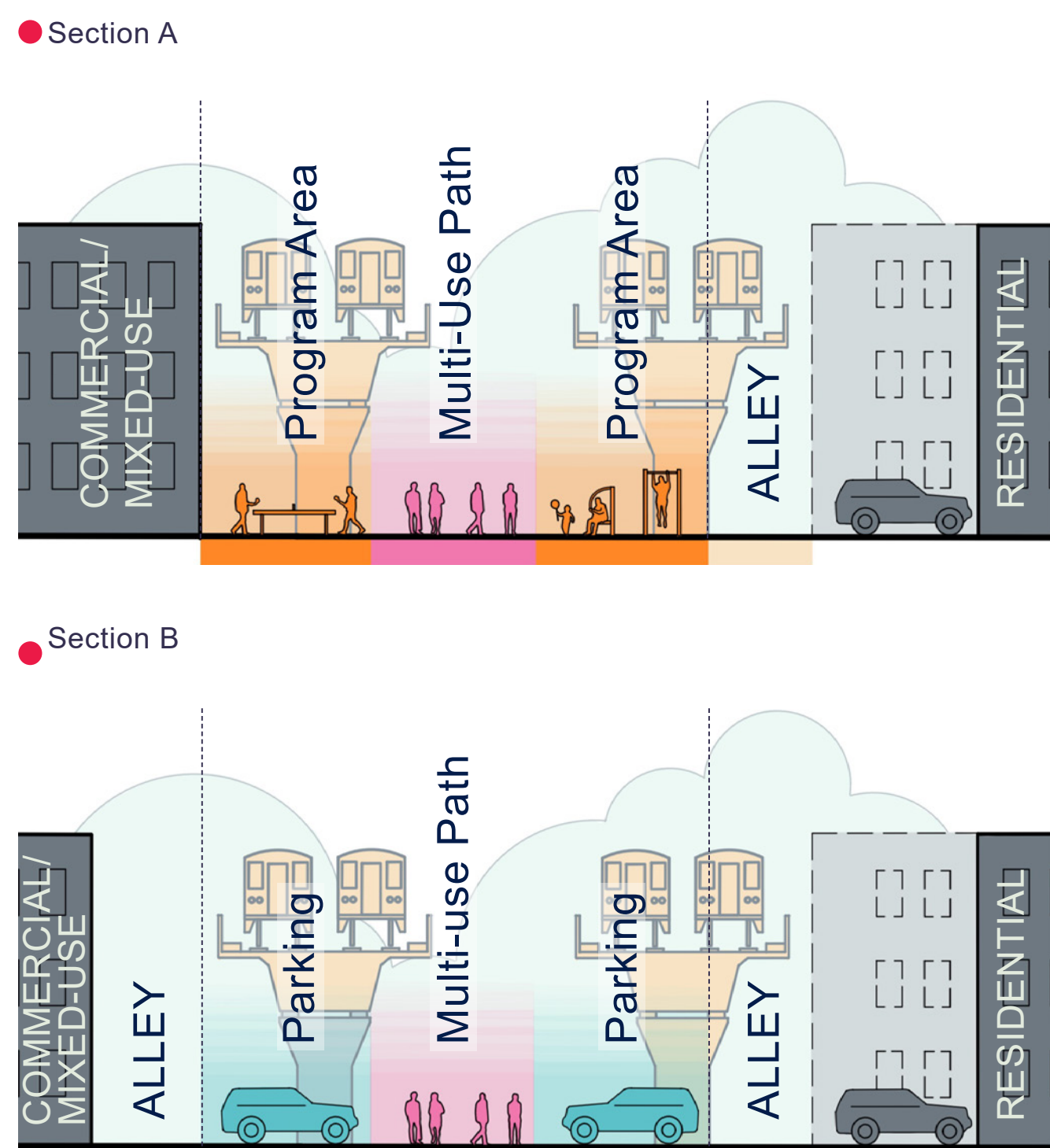
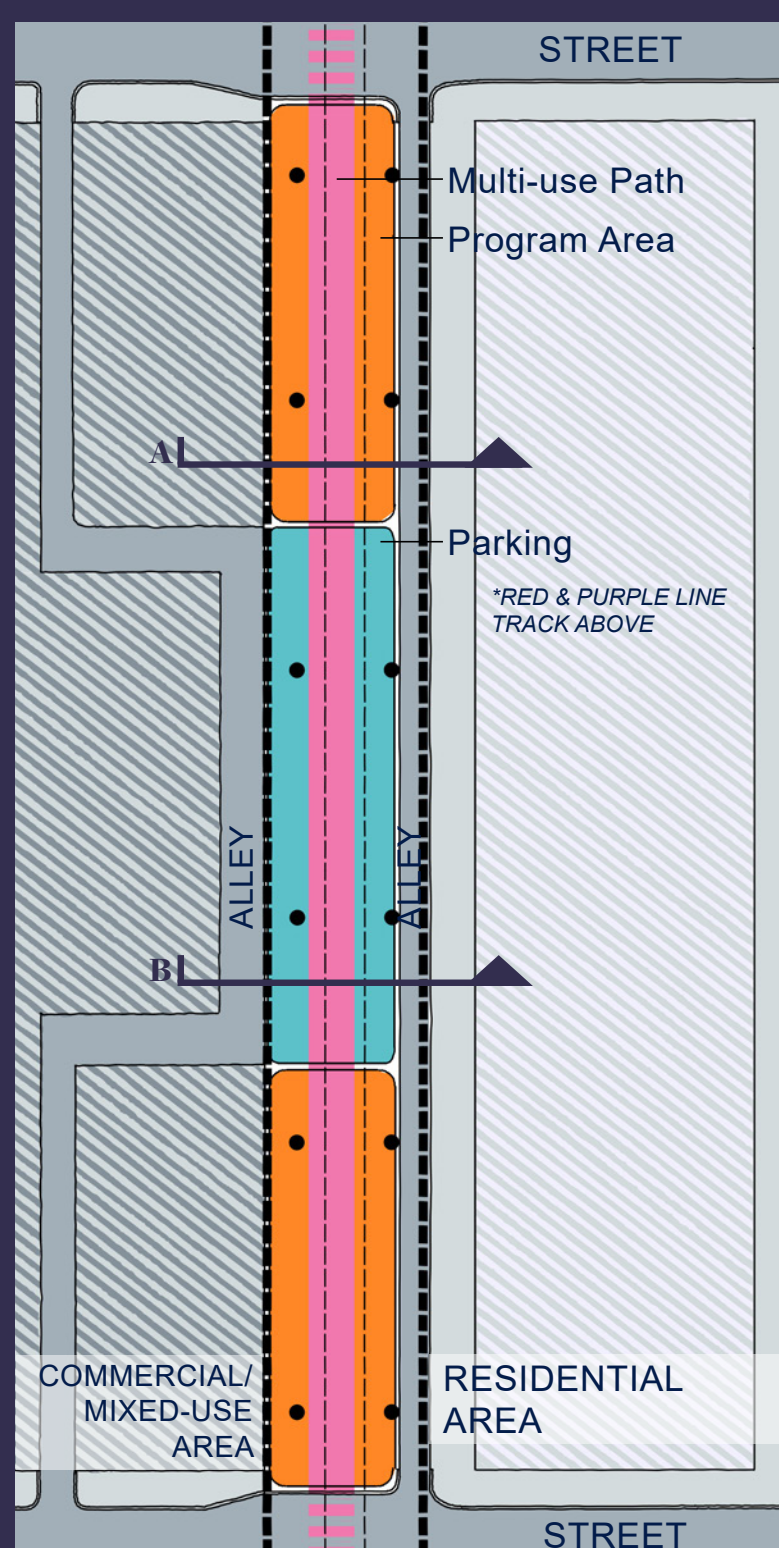
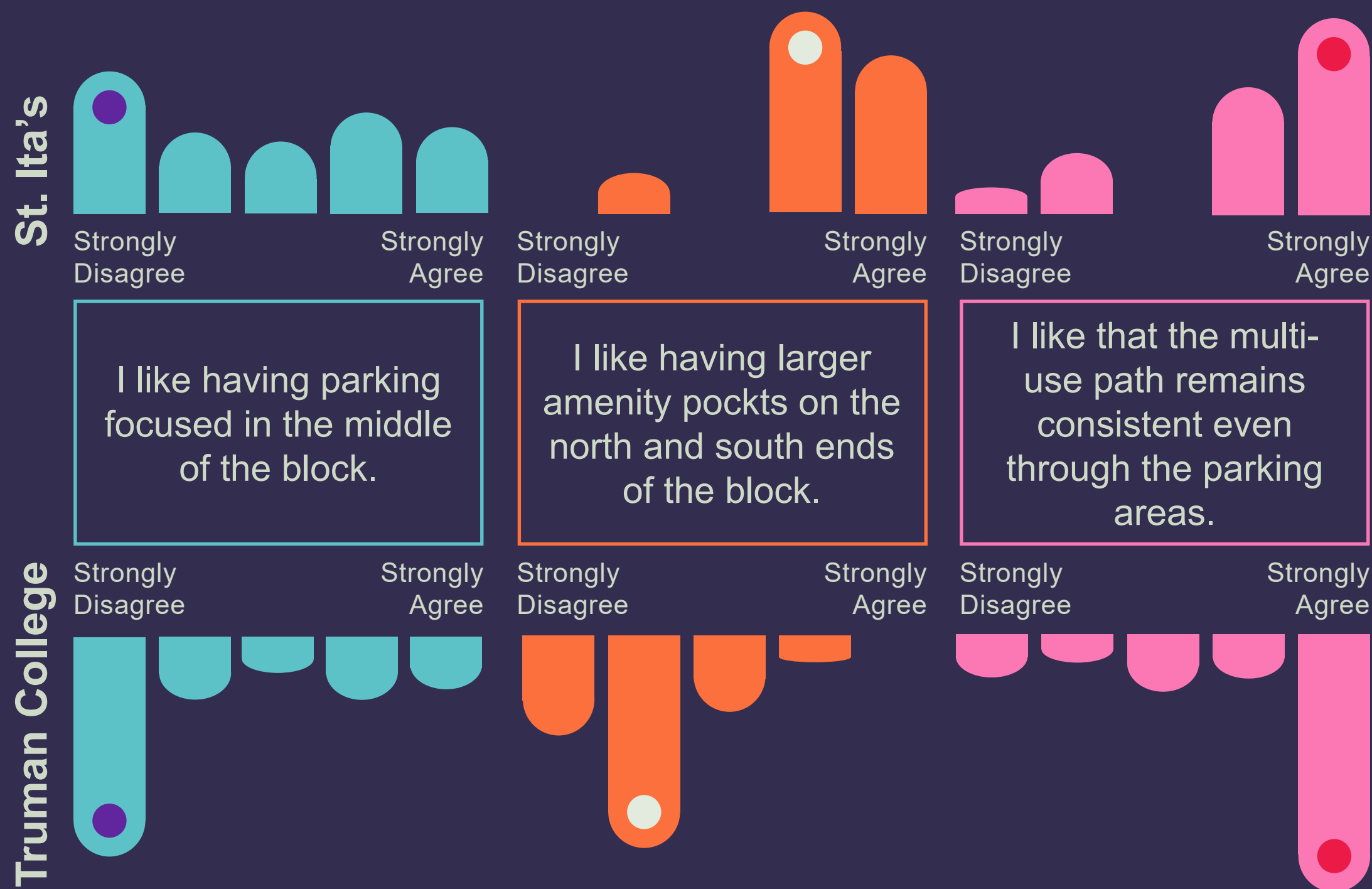

Layout 3

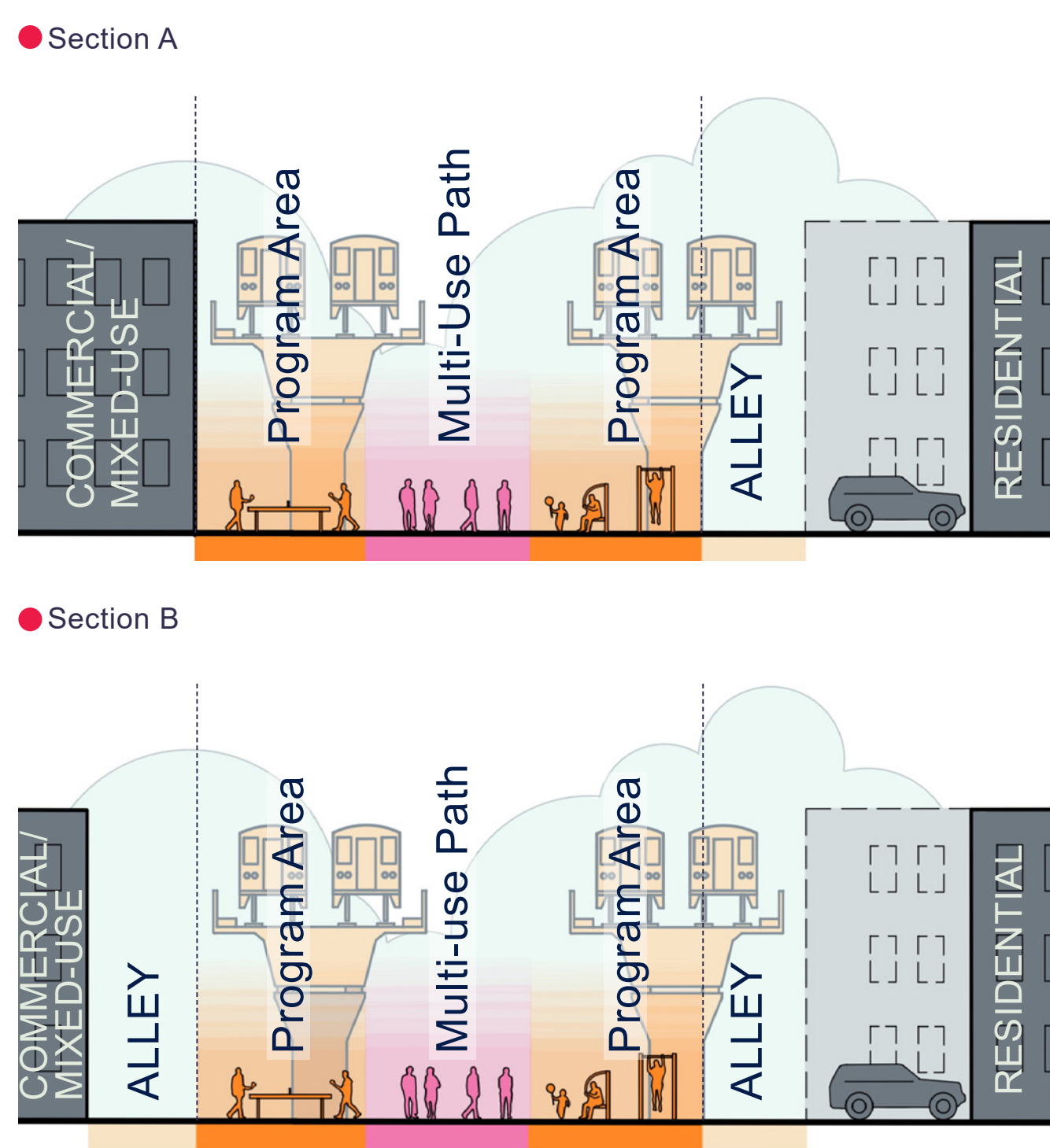
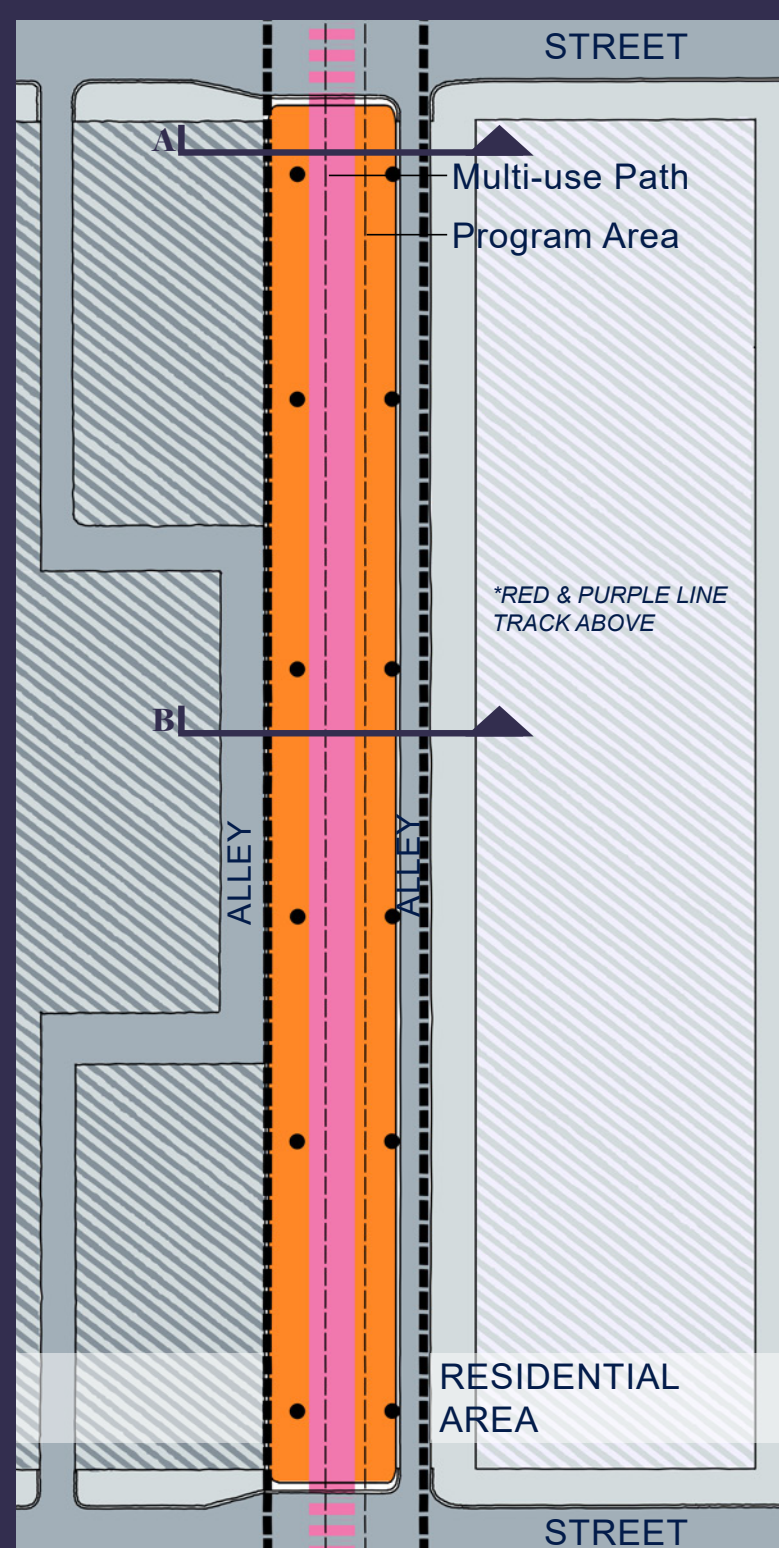
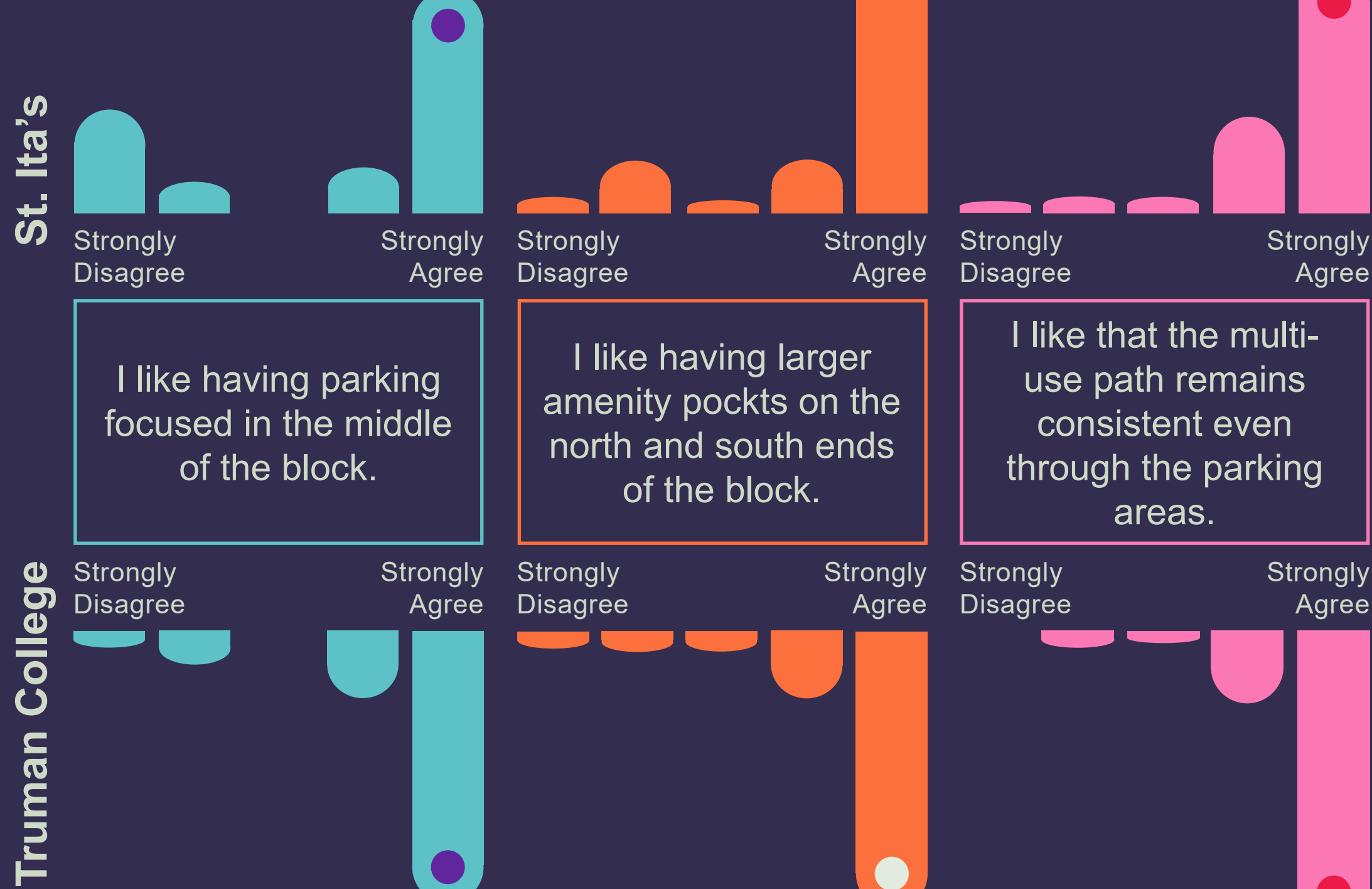

F E E D B A C K

S U M M A R Y

Extreme majority of feedback was to not have parking at all eight blocks of activation.

Extreme majority of feedback wanted continuous programmed spaces throughout the block.

Majority of feedback would use a consistent multi-use path.

L A W R E N C E T O B R Y N M A W R U N D E R ' L ' A C T I V A T I O N

PROGRAM FEEDBACK

Legend

- Public Art / Mural
- Outdoor Fitness
- Dog Park
- Playground/ Playscape
- Market Place
- Sports Court
- Park Space
- Open Plaza / Event Space
- Skate Park
- Community Garden
- Nature Play
- Parking
- Stormwater Feature
- Bike Parking
- Seating Area

Most Desired Program



Program Desire by Block

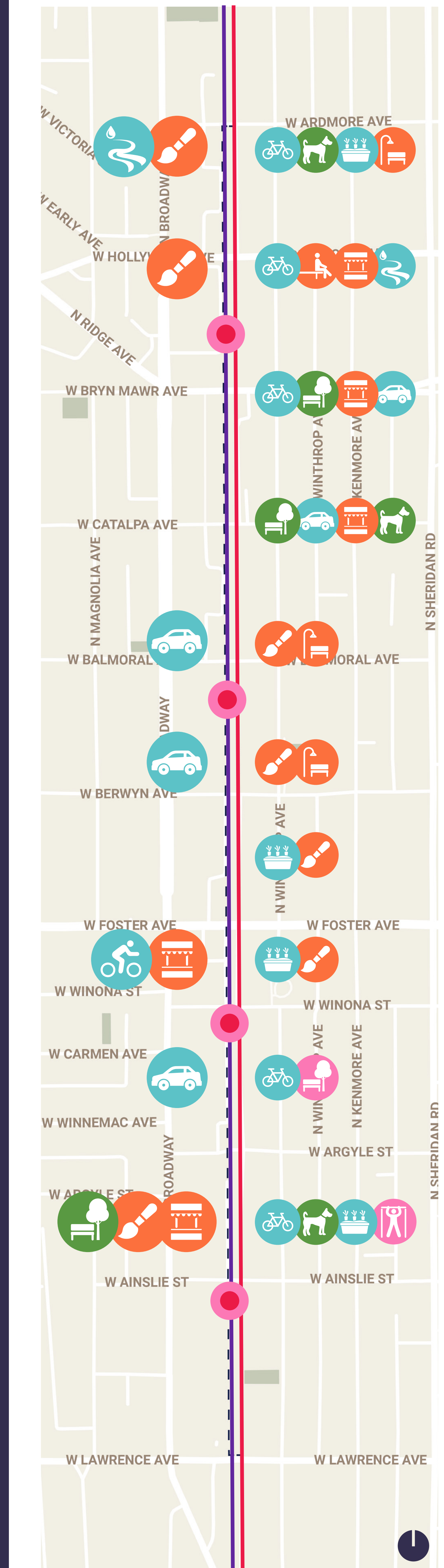

FEEDBACK SUMMARY

St. Ita's

Truman College

Extreme majority of focus was the desire for parking between Balmoral and Foster.

Moderate focus between Ardmore and Balmoral with the most common interest in Public art and Vendor Market.

Slight peak in dog park interest between Catalpa and Berwyn.

Extremely high interest / concern regarding parking and safety.

Moderately high interest in public art and pedestrian space.

Moderately High interest / concern in vendor markets, design direction for the space, the issue of trash and having a community garden.

Majority of focus for programmed areas were at segment Ainslie to Lawrence with some moderately high focus at segments Argyle to Ainslie and Winona to Argyle.

Most desired program was Park space, Vendor Market, Public Art and Bike parking.

Slight peak in bike parking interest between Hollywood and Catalpa.

Vendor Market mentioned most.

Moderately high interest/concern in multi-modal traffic - including parking, traffic, bike traffic / bike parking and safety.

Moderate interest / concern in green space and planting as well a community oriented design and space for pop-ups.

LAWRENCE TO BRYN MAWR UNDER 'L' ACTIVATION

S I T E C O N D I T I O N S

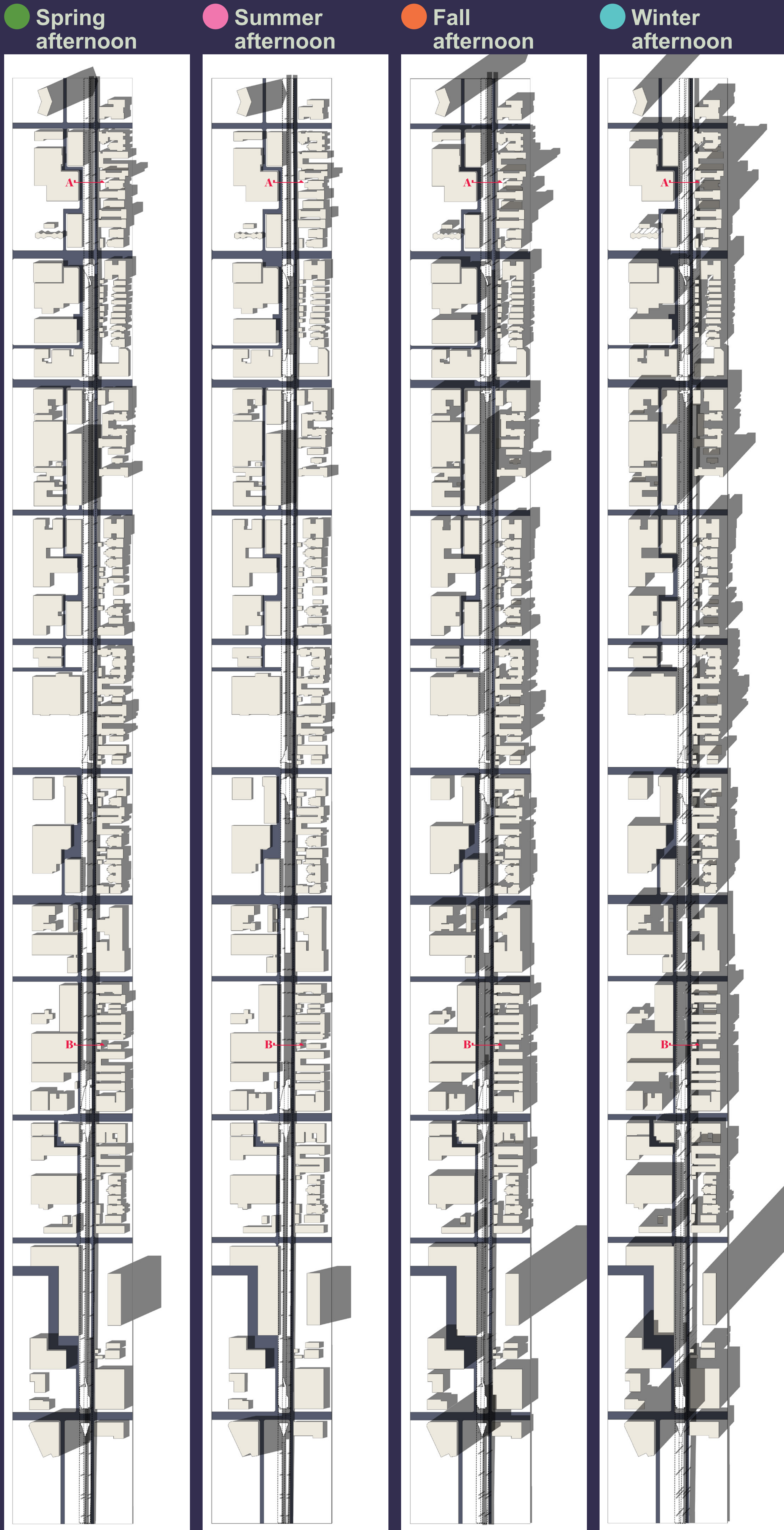

Section Conditions

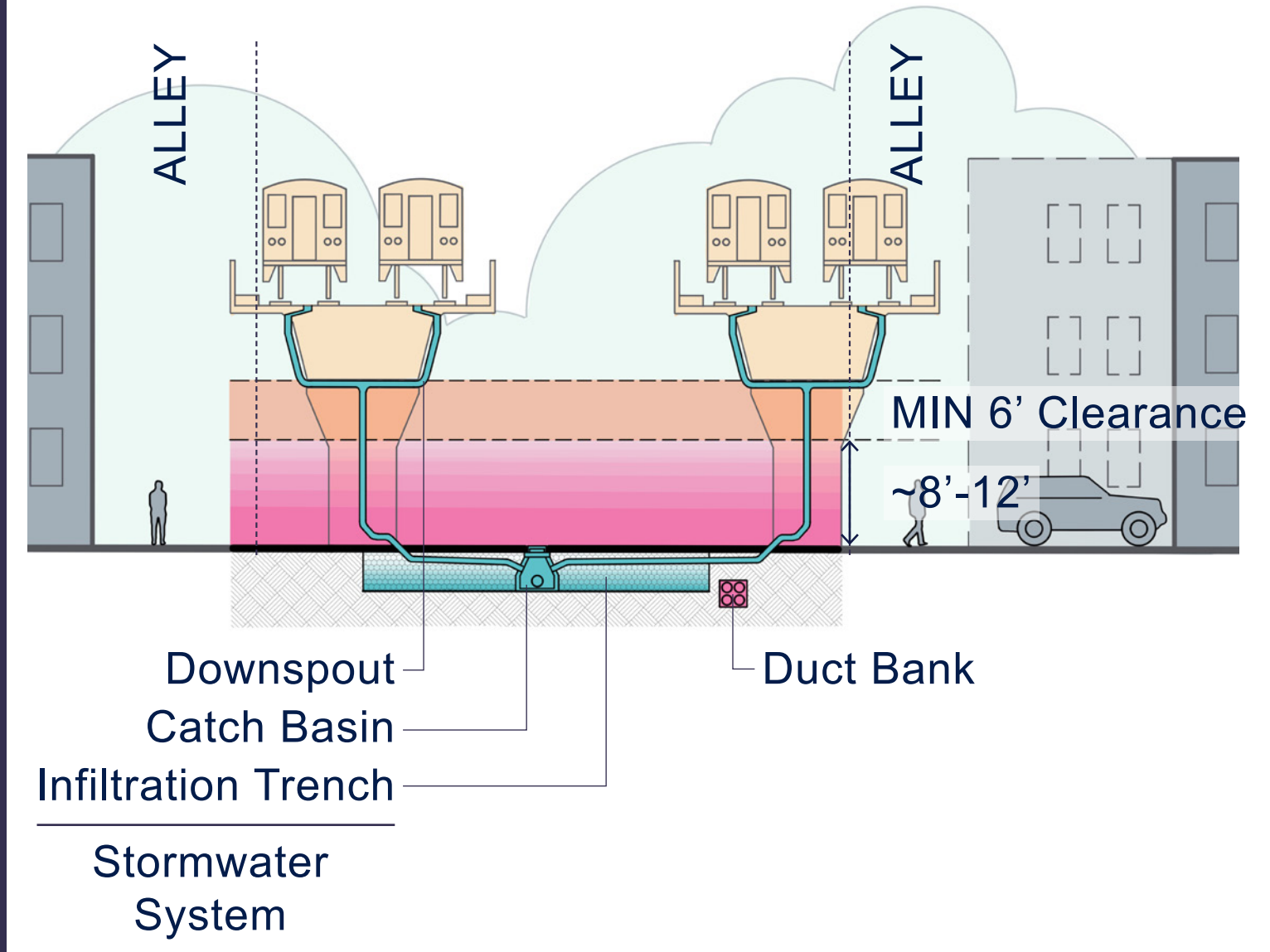

SECTION A - Typical Section

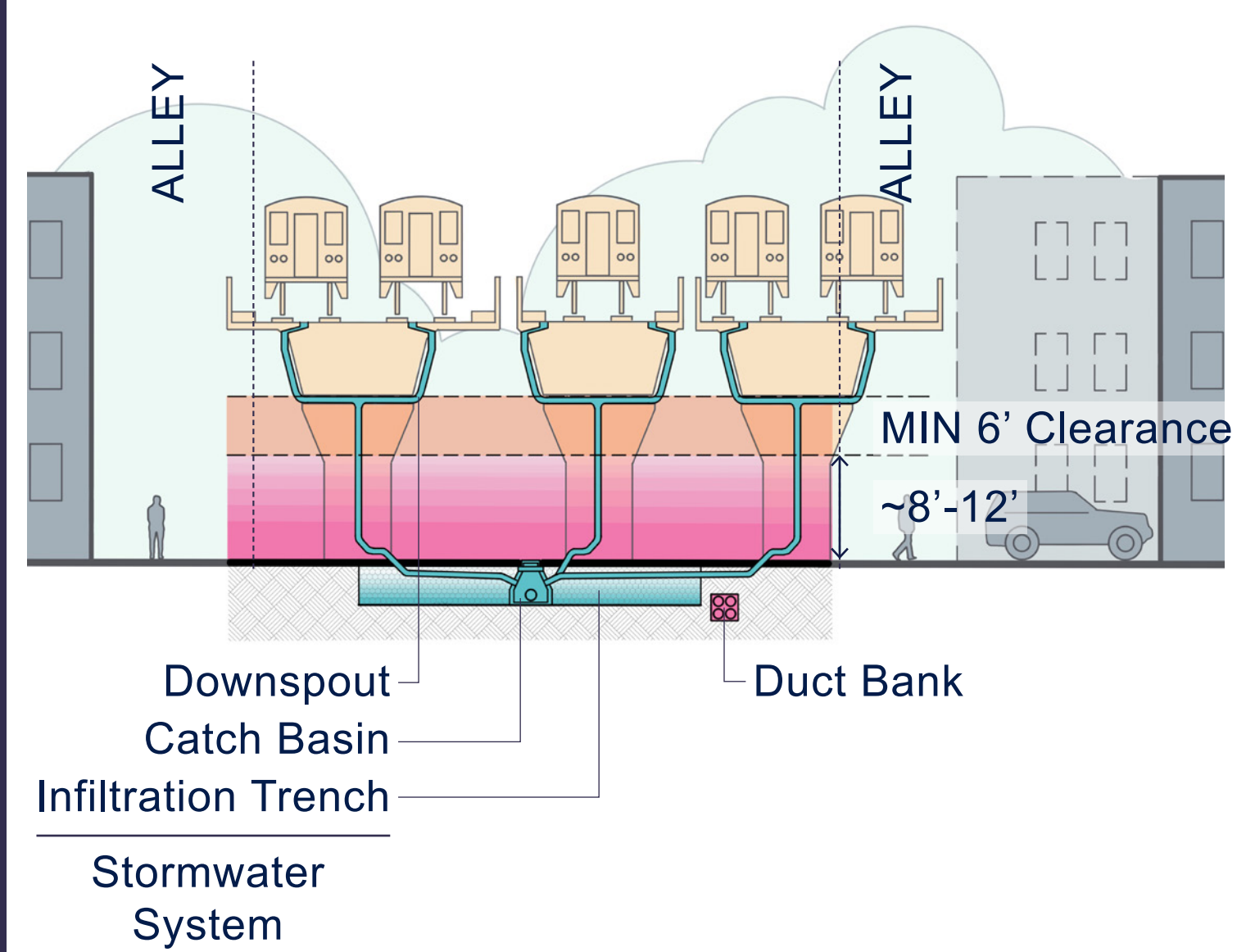

SECTION B - Typical Section at Pocket Track

Site Constraints



Ensure CTA equipment access is maintained



No attachments to the elevated track



Protect underground stormwater and utility systems

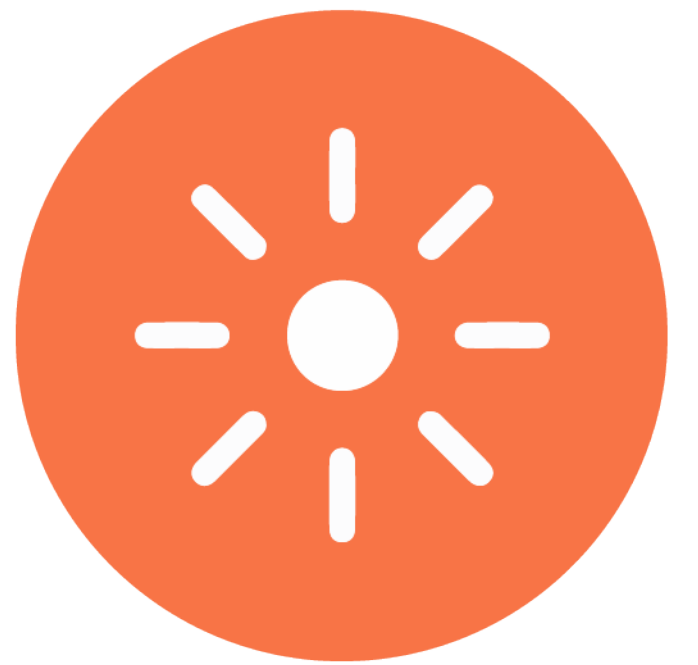

Limited sunlight

S I T E A D J A C E N C I E S

Legend

Surrounding Programming

- 1** EdgeFest (August 5th)
- 2** Edgewater yard and sidewalk sale (June)
- 3** Edgewater Winter Bryn Mawrkets & Gallery
- 4** Argyle Night Market (July-August)
- 4** Lunar New Year Parade (January/February)
- 5** Buttercup Park: Chicago Park District events
- 6** Uptown walking tours (summer)
- 7** Casino Uptown (October/November)
-  Bands on Broadway

Adjacent Buildings

-  Retail & restaurant
-  Educational institutes
-  Community anchors
-  Theaters & performance venues
-  Commercial corridors

Site Programming

-  Active
-  Commercial
-  Educational
-  Passive
-  Play

Amplifying Neighborhood Assets

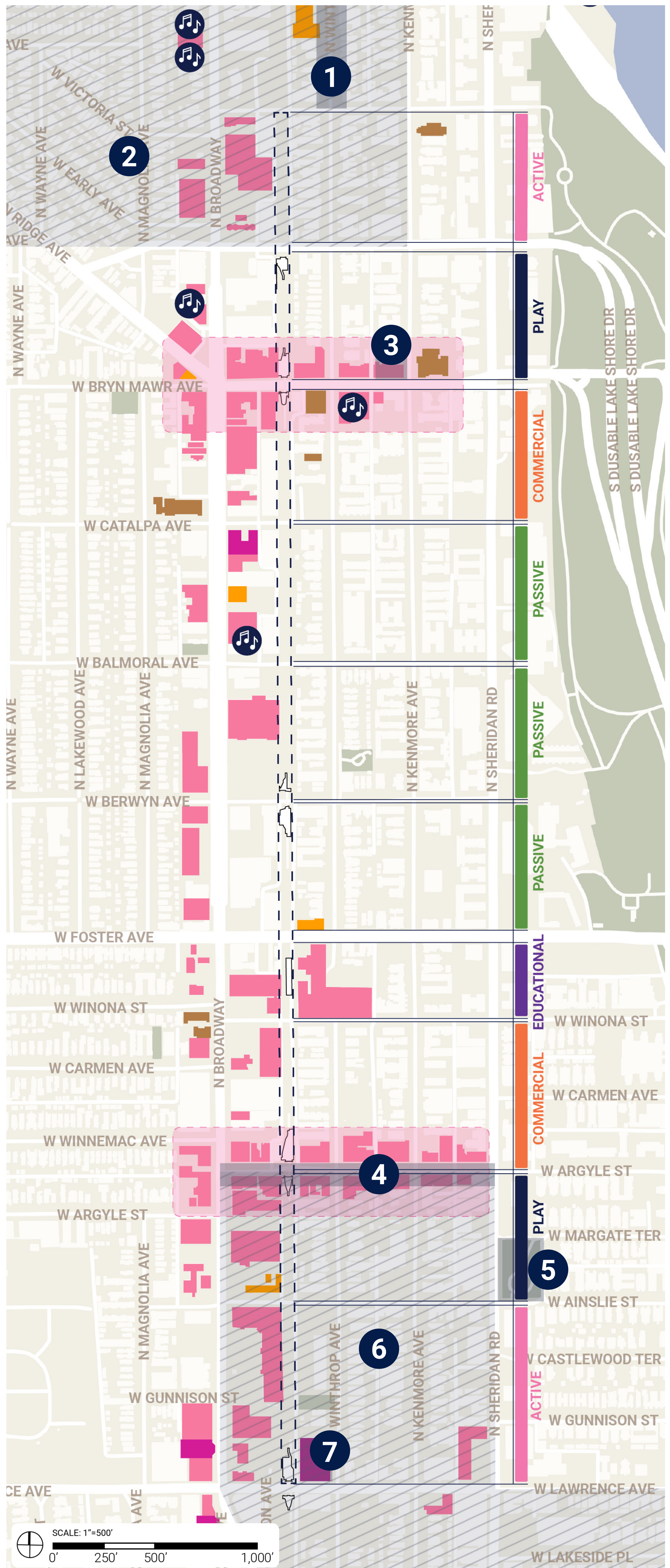
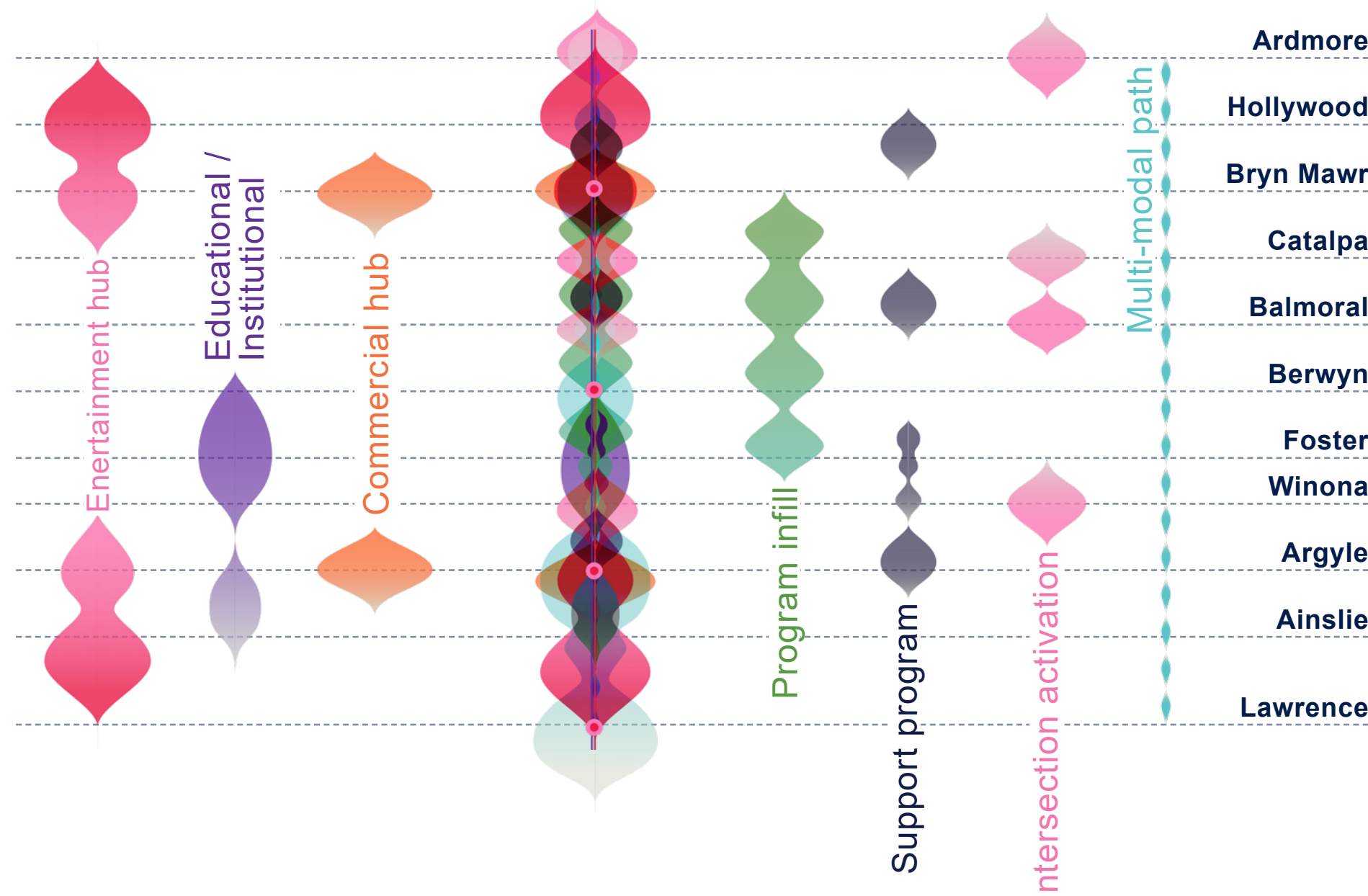

LAWRENCE TO BRYN MAWR UNDER 'L' ACTIVATION

PROGRAM LAYOUT

Legend

- Outdoor Fitness
- Dog Park
- Playground / Playscape
- Market Place
- Nature Play
- Parking
- Sports & Games
- Park Space
- Open Plaza / Event Space
- Skate Park
- Stormwater Feature
- Bike Parking

Program Area Hierarchy

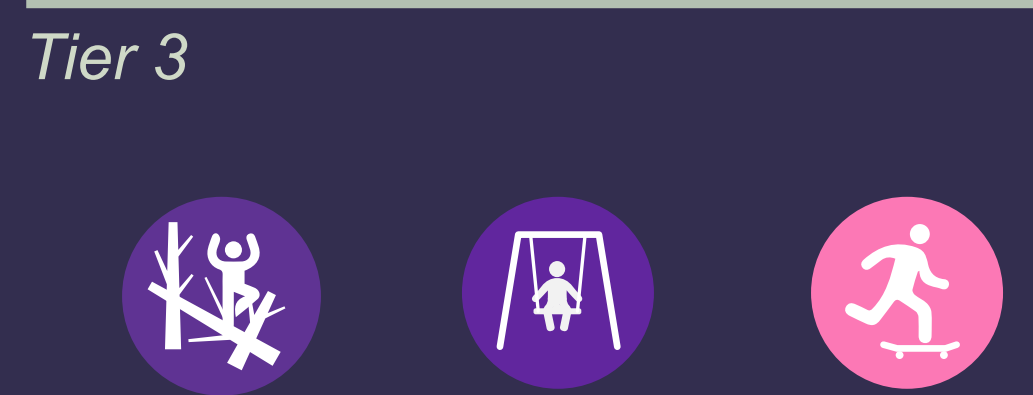

Most space allocation

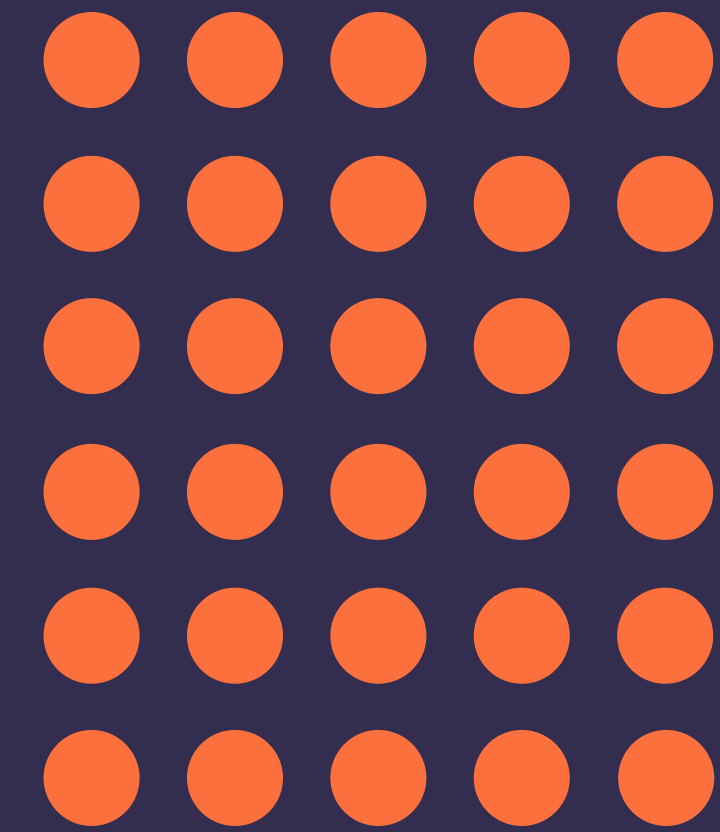

Plaza, Market and Event Space, Bike Parking: 90000SF

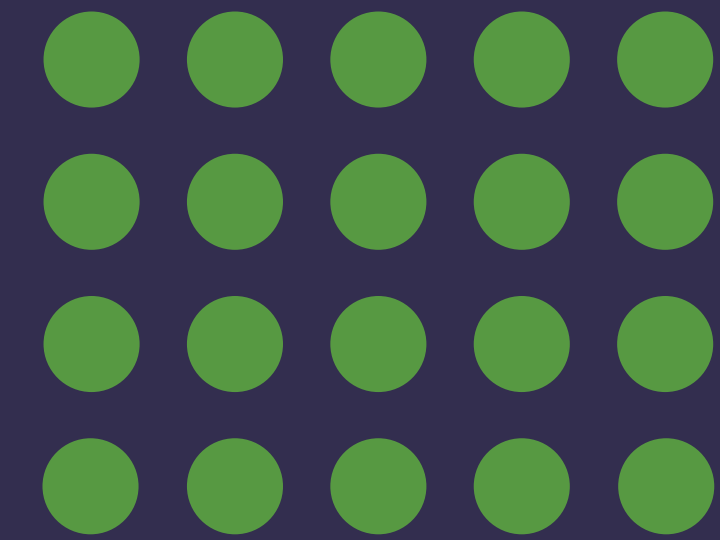

Park Space: 61000 SF



Parking: 20000 SF

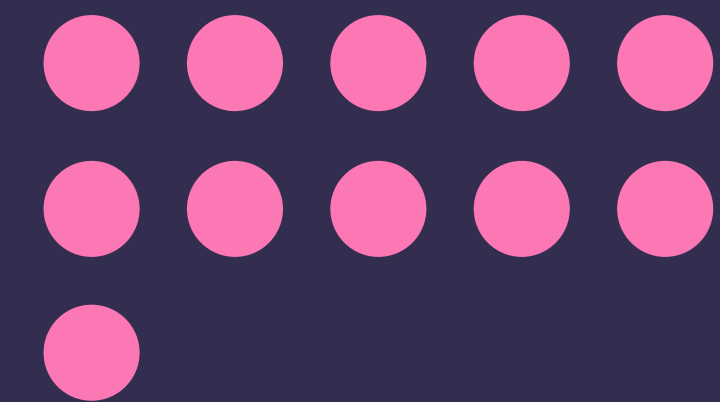

Sports Court: 17000 SF
Outdoor Fitness: 12000 SF



Dog Park: 16000 SF



Stormwater Feature: 15000 SF



Seating Area: 13000 SF



Nature Play: 12000 SF



Play Area: 7000 SF
Skate Park: 6000 SF

Least space allocation

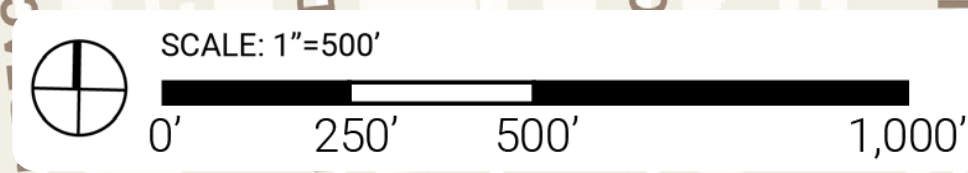
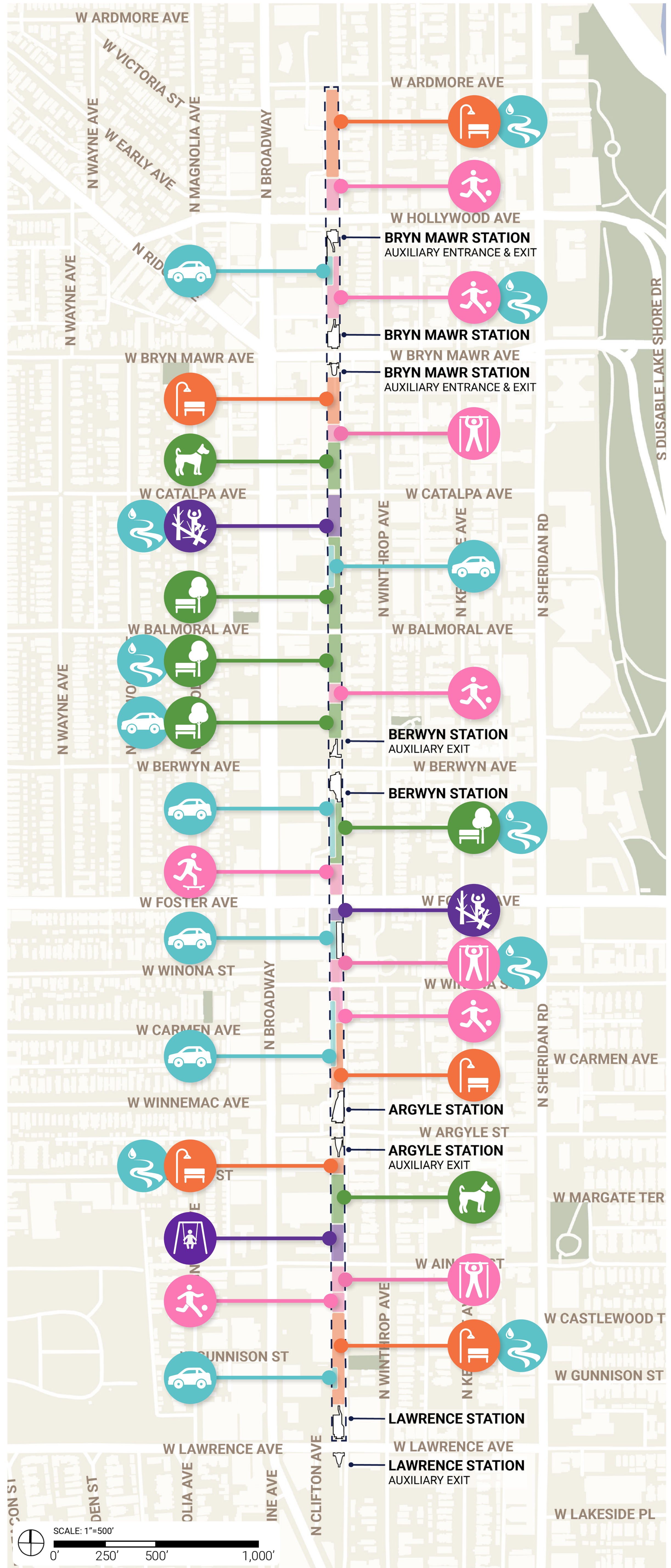

LAWRENCE TO BRYN MAWR UNDER 'L' ACTIVATION





PROGRAM ELEMENTS

WHAT DO YOU WANT TO SEE IN YOUR PLAZA SPACES?



● Stage

Grid of 20 empty circles for selecting the 'Stage' element.



● Unique Seating

Grid of 20 empty circles for selecting the 'Unique Seating' element.



● Nook Seating

Grid of 20 empty circles for selecting the 'Nook Seating' element.



● Lounge Seating

Grid of 20 empty circles for selecting the 'Lounge Seating' element.



● Open Space / Market

Grid of 20 empty circles for selecting the 'Open Space / Market' element.



● Terraced Seating

Grid of 20 empty circles for selecting the 'Terraced Seating' element.



● Continuous Element

Grid of 20 empty circles for selecting the 'Continuous Element' element.



● Group Seating

Grid of 20 empty circles for selecting the 'Group Seating' element.



● Lawn Games on Turf

Grid of 20 empty circles for selecting the 'Lawn Games on Turf' element.



● Artful Seating

Grid of 20 empty circles for selecting the 'Artful Seating' element.



● Game Tables

Grid of 20 empty circles for selecting the 'Game Tables' element.



● Seating Sculpture

Grid of 20 empty circles for selecting the 'Seating Sculpture' element.



● Dog Friendly Elements

Grid of 20 empty circles for selecting the 'Dog Friendly Elements' element.



● Outdoor Movie Area

Grid of 20 empty circles for selecting the 'Outdoor Movie Area' element.



● Bike Amenities

Grid of 20 empty circles for selecting the 'Bike Amenities' element.



● Public Art / Sculpture

Grid of 20 empty circles for selecting the 'Public Art / Sculpture' element.

LAWRENCE TO BRYN MAWR UNDER 'L' ACTIVATION



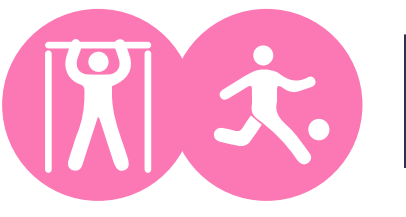

PROGRAM ELEMENTS

WHAT KIND OF **FITNESS / SPORTS ELEMENTS** DO YOU WANT TO SEE?

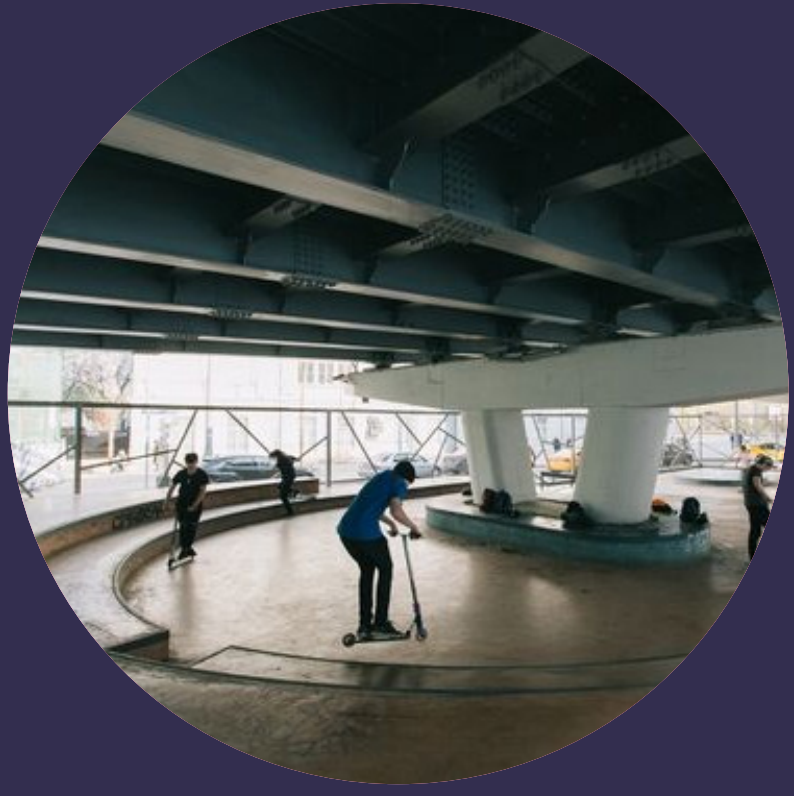

● Skate Park

Grid of 20 empty circles for voting.



● Basketball Hoops

Grid of 20 empty circles for voting.



● Table Tennis

Grid of 20 empty circles for voting.



● 4-way Volleyball

Grid of 20 empty circles for voting.



● Climbing Wall

Grid of 20 empty circles for voting.



● Pump Track

Grid of 20 empty circles for voting.



● Contained Football

Grid of 20 empty circles for voting.



● Land Curling

Grid of 20 empty circles for voting.



● Fitness Loop

Grid of 20 empty circles for voting.



● Fun Track

Grid of 20 empty circles for voting.



● Hamster Wheel

Grid of 20 empty circles for voting.



● Ground Trampoline

Grid of 20 empty circles for voting.



● Battle Rope

Grid of 20 empty circles for voting.



● Calisthenics

Grid of 20 empty circles for voting.



● Outdoor Gym

Grid of 20 empty circles for voting.



● Reflexology Path

Grid of 20 empty circles for voting.

LAWRENCE TO BRYN MAWR UNDER 'L' ACTIVATION

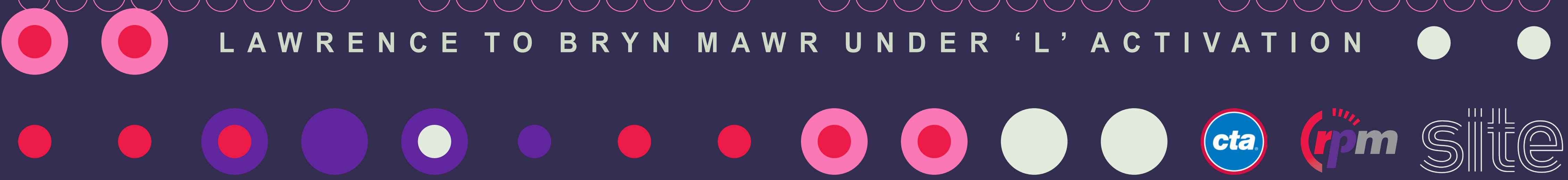

PROGRAM ELEMENTS

WHAT KIND OF **PLAY ELEMENTS** DO YOU WANT TO SEE?



● Repurposed Natural Materials

Grid of 40 empty circles for selection.



● Traditional Play Equipment

Grid of 40 empty circles for selection.



● Embankment Slide

Grid of 40 empty circles for selection.



● Playful Topography

Grid of 40 empty circles for selection.



● Play Structures

Grid of 40 empty circles for selection.



● Play Sculptures

Grid of 40 empty circles for selection.



● Tactile Play Wall

Grid of 40 empty circles for selection.



● Contained Play Area

Grid of 40 empty circles for selection.



● Log Stump Scramble

Grid of 40 empty circles for selection.



● Play Ribbon

Grid of 40 empty circles for selection.



● PIP Rubber Forms

Grid of 40 empty circles for selection.



● Playful Furniture

Grid of 40 empty circles for selection.



● Net Playscape

Grid of 40 empty circles for selection.



● Land Bridge

Grid of 40 empty circles for selection.



● Games Striping

Grid of 40 empty circles for selection.



● Trike Track

Grid of 40 empty circles for selection.

LAWRENCE TO BRYN MAWR UNDER 'L' ACTIVATION



DESIGN ELEMENTS

WHAT KIND OF **PLACEMAKING** DO YOU WANT TO SEE?



● Feature light poles

Grid of 20 pink circles for rating.



● Pavement pattern

Grid of 20 pink circles for rating.



● Wayfinding

Grid of 20 pink circles for rating.



● Signature colors

Grid of 20 pink circles for rating.



● Ground light displays

Grid of 20 pink circles for rating.



● Murals

Grid of 20 pink circles for rating.



● Reused elements

Grid of 20 pink circles for rating.



● Ground wayfinding

Grid of 20 pink circles for rating.



● Structure color washing

Grid of 20 pink circles for rating.



● Information kiosks

Grid of 20 pink circles for rating.



● Planting design

Grid of 20 pink circles for rating.



● Educational plaques

Grid of 20 pink circles for rating.



● Illuminated furniture

Grid of 20 pink circles for rating.



● Light sculpture

Grid of 20 pink circles for rating.



● Light pavement

Grid of 20 pink circles for rating.



● Sculpture / art

Grid of 20 pink circles for rating.

LAWRENCE TO BRYN MAWR UNDER 'L' ACTIVATION