

# Red Line Extension Station Plazas Community Meetings



103rd Street Red Line Station



111th Street Station



Michigan Avenue Red Line Station



130th Street Red Line Station



# Agenda for today

- **Project overview**
- **Project schedule**
- **Current work**
- **Plaza enhancements**
- **Next steps**



# Red Line Extension project overview

- **5.5-mile Red Line Extension from the 95th Street Terminal to 130th Street**
- **Four new stations at 103rd Street, 111th Street, Michigan Avenue near 116th Street and 130th Street**
- **Parking and bus connections at each new station**
- **New train storage yard and maintenance facility at 120th Street**



# Project schedule

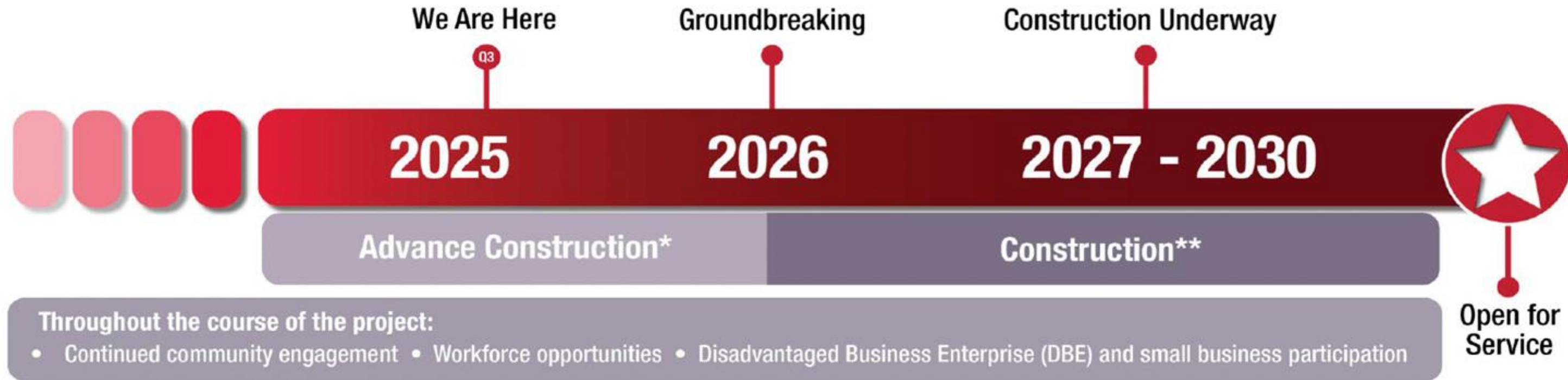

## Accomplishments to date:

- Federal, state and local Transit Tax Increment Financing (TIF) funding secured
- Transit-Supportive Development (TSD) Plan adopted
- Contract to design and build RLE Project awarded to Walsh VINCI Transit Community Partners
- Contracts with workforce agencies for RLE training and jobs awarded

*\*Advance construction includes property demolition and utility equipment relocation.*

*\*\*Preparatory construction work including surveying and soil boring is now under way by Walsh VINCI.*

*Exact dates are subject to change as the project advances.*

# Recent construction activity

Property demolition where new Red Line track will be built



Soil boring work ahead of drilling new foundations for future track



# Station plaza enhancements & community engagement: Goals and purpose for today's meeting

**We want to hear from you:**



**How do you see the community using the spaces around the new 103rd Street, 111th Street and Michigan Avenue stations?**



**You'll see examples of types of features in three categories.**

- Landscaping
- Plaza pavers
- Seating



**Station plaza vibe:**

What kind of mood or feeling should the plaza area create?

# Station plaza areas: site constraints



**Ensure CTA  
equipment access  
is maintained**



**No attachments to  
the track or station**



**Protect  
underground  
stormwater and  
utility systems**

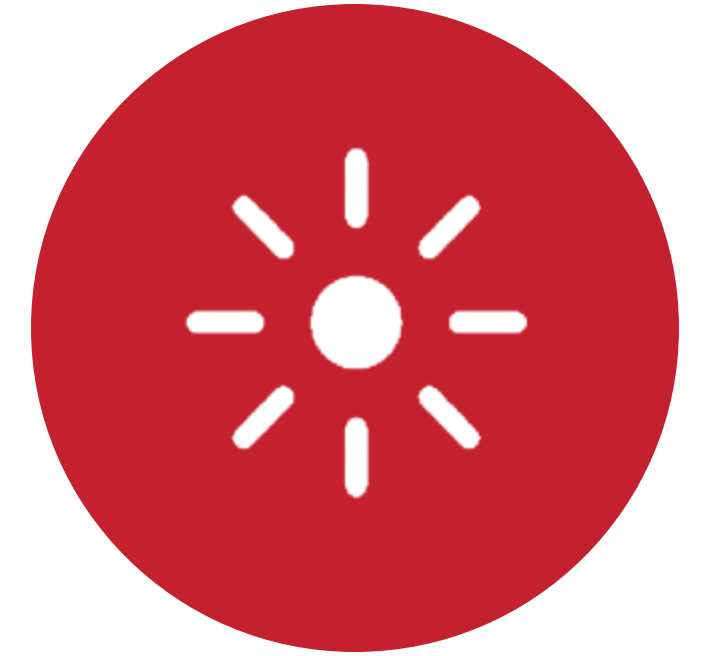

**Limited sunlight**

# Next stop: CTA 103rd Street station



# About the new 103rd Street station

- Will include elevators and escalators in main stationhouse on north side of W. 103rd St
- Exit-only auxiliary station on south side of W. 103rd St
- Parking, bike storage, connections with CTA bus service
- Stations are designed to meet CTA rail standards
- Station expected to open in 2030



# 103rd Street station plaza

## How will the community use this public space?

W 103RD STREET  
ENHANCEMENT AREAS

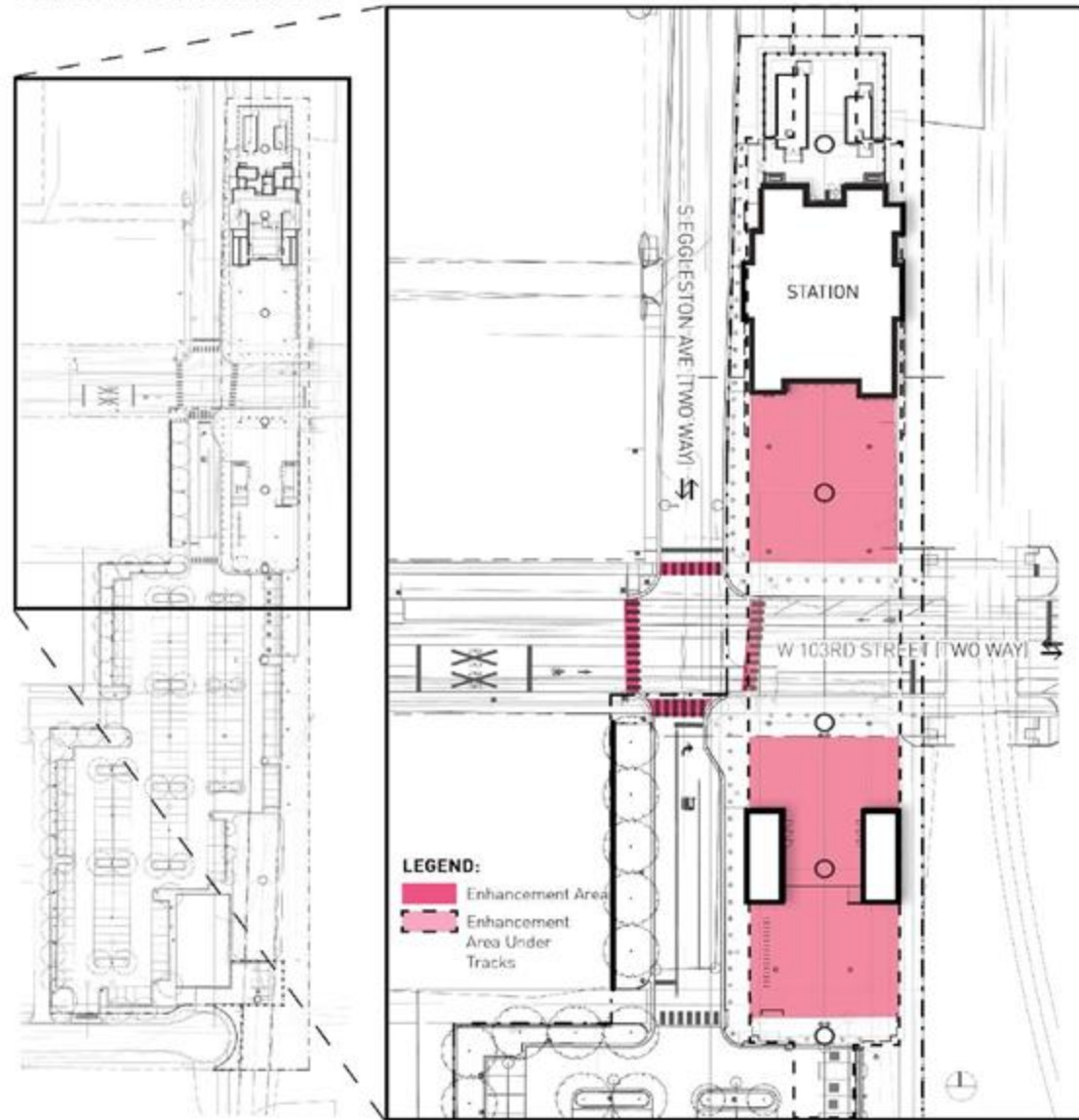

PLAN ENLARGEMENT

W 103RD STREET  
ENHANCEMENT AREAS



# Next stop: CTA 111th Street station



# About the new 111th Street station

- Will include elevators and escalators in main stationhouse on north side of 111th St.
- Exit-only auxiliary station at approximately 110th Place
- Parking, bike storage, connections with CTA bus service
- Stations are designed to meet CTA rail standards
- Station expected to open in 2030



# 111th Street station plaza

How will the community use this public space?

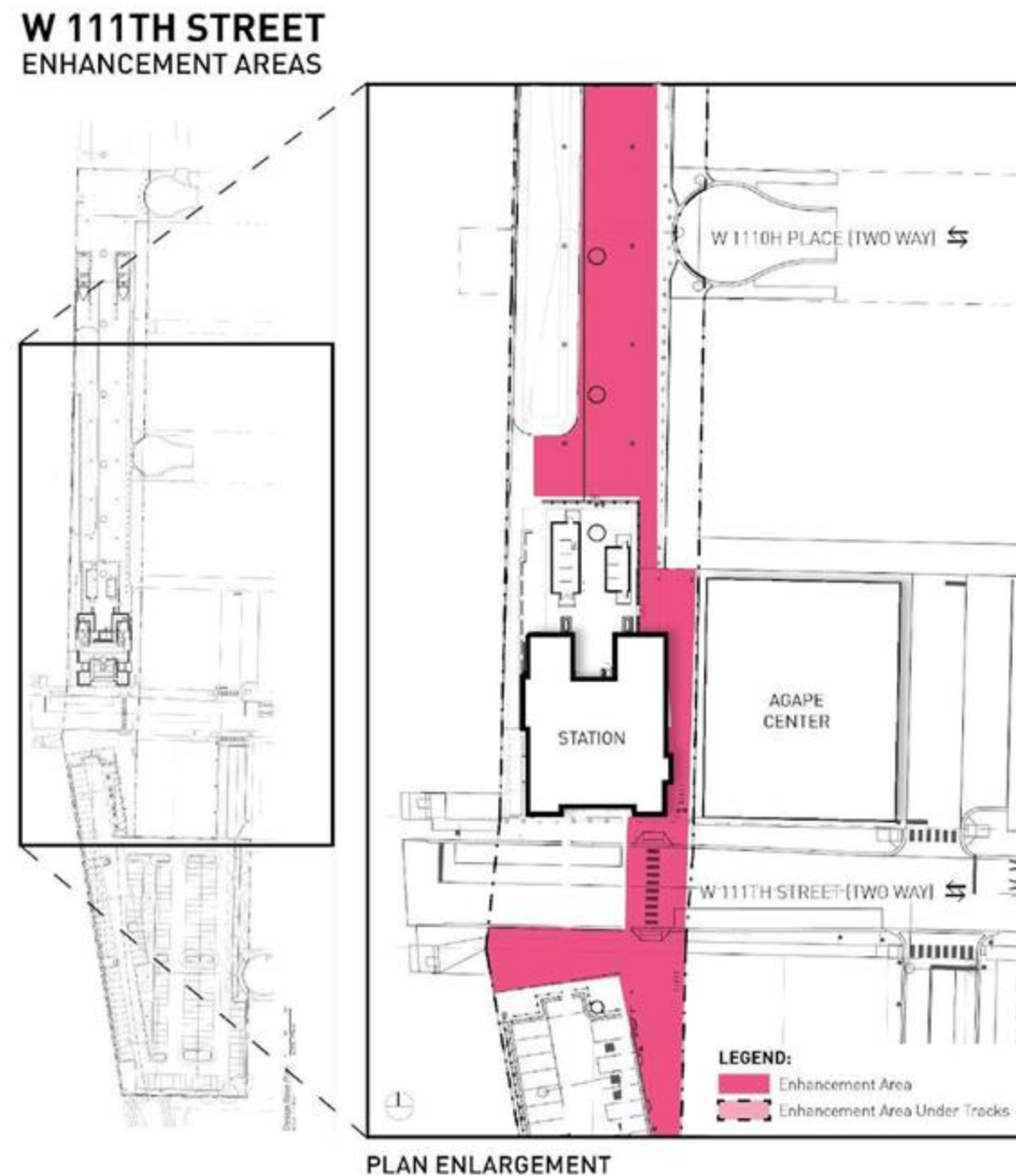

# Next stop: CTA Michigan Avenue station



# About the new Michigan Avenue station

- Will include elevators and escalators in main stationhouse on the west side of S. Michigan Ave, south of E. Kensington Ave.
- Exit-only auxiliary station east of S. Michigan Ave. and south of E. Kensington Ave.
- Parking, bike storage, connections with CTA bus service
- Stations are designed to meet CTA rail standards
- Station expected to open in 2030



# Michigan Avenue station plaza

## How will the community use this public space?

S MICHIGAN AVENUE  
ENHANCEMENT AREAS

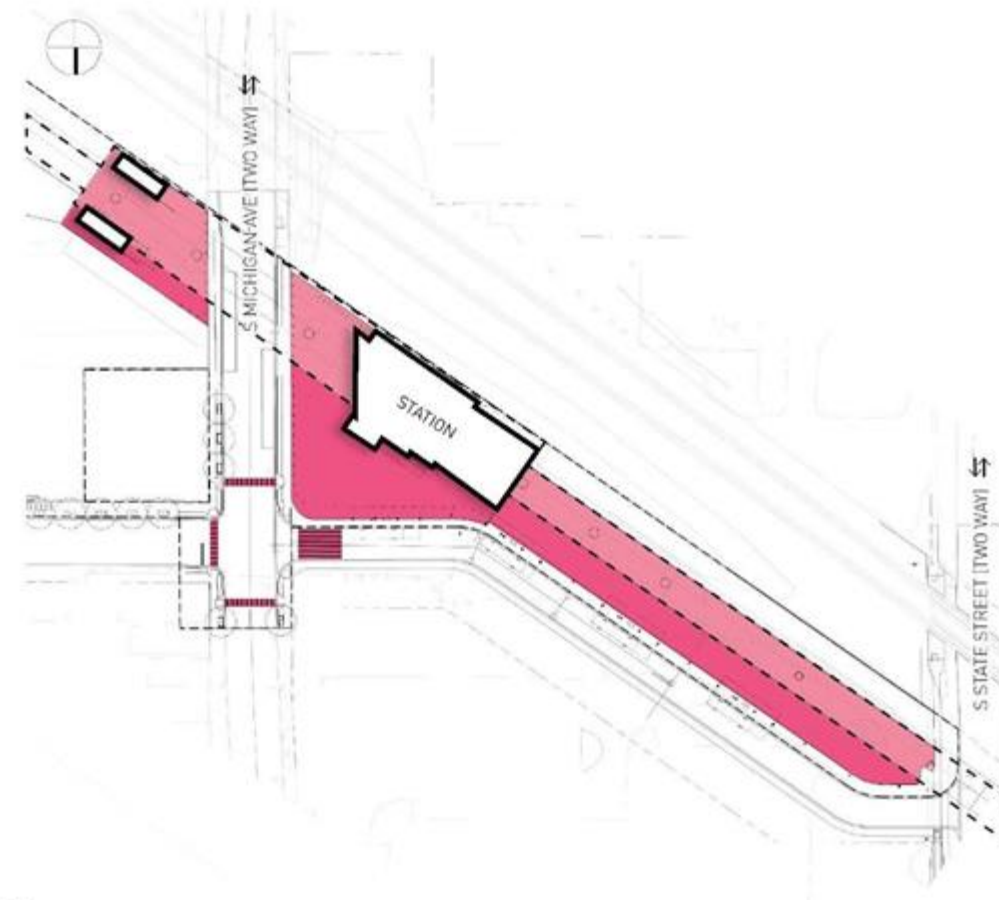

**LEGEND:**

- Enhancement Area
- Enhancement Area Under Tracks

S MICHIGAN AVENUE  
ENHANCEMENT AREAS



# Next Stop: CTA 130th Street station!



# About the new 130th Street station

- **Parking, bike storage, connections with CTA bus service**
- **Station expected to open in 2030**



# 130th Street station plaza

How will the community use this public space?

E 130TH STREET  
ENHANCEMENT AREAS



E 130TH STREET  
ENHANCEMENT AREAS

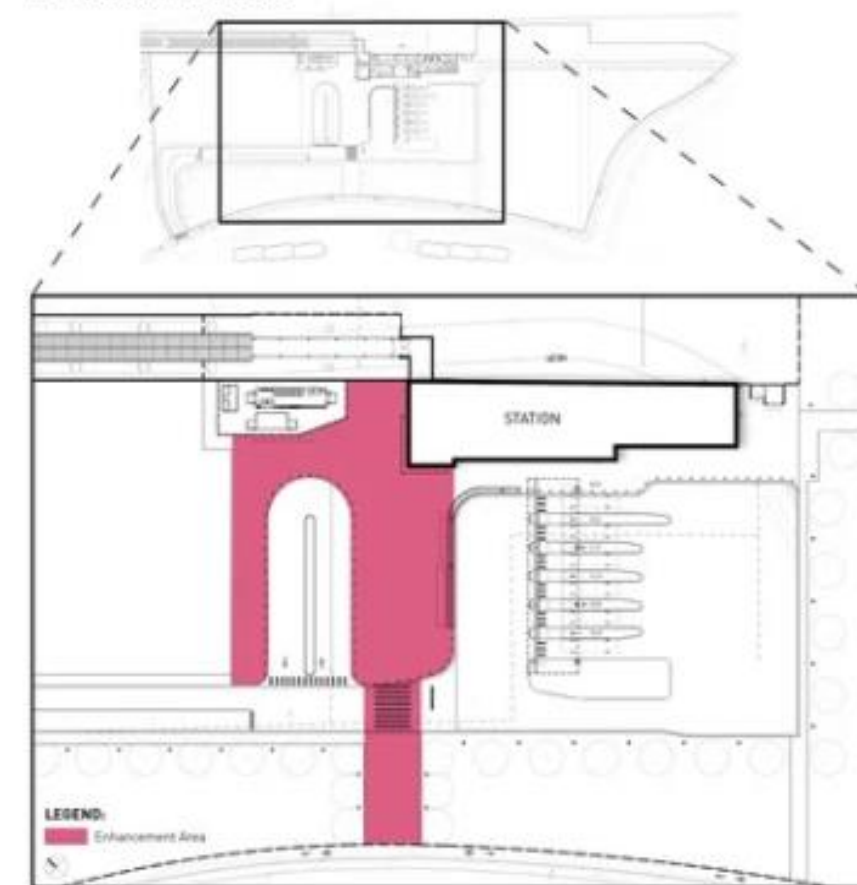

# How we will organize the community meetings:

Each station will have its own dedicated area at the community meetings to allow residents to visit the station of their choice.

The station areas will feature boards with sample enhancement concepts in three categories:

● Landscaping

● Plaza pavers

● Seating

# Station landscaping: sample concepts



# Plaza pavers: sample concepts



# Station seating: sample concepts



# How to share your feedback with us

- Visit the boards for your station in the room – multiple boards for each station
- Using sticky notes, comment cards or other means, tell us what you like – or don't like
- We will also collect comments via email to [RedExtension@transitchicago.com](mailto:RedExtension@transitchicago.com) or leave us a message at **(312) 772-2272**.
- We will accept comments through **11:59 p.m. Sunday, Oct. 12, 2025**.



# Next steps



**We are collecting comments and suggestions now**



**We expect to hold our next series of meetings in November to present final design concepts**



**Groundbreaking for new track and station construction begins in 2026!**

